



4th European Conference on Schizophrenia Research

Together for better treatment and care

Joint thematic congress of the European Scientific Association on Schizophrenia and other Psychoses (ESAS), the Competence Network on Schizophrenia (CNS), the European Psychiatric Association (EPA), and German Association for Psychiatry, Psychotherapy and Psychosomatics (DGPPN)

26 – 28 September 2013
Berlin, Germany

in cooperation with



World Psychiatric Association (WPA)
and its Section on Schizophrenia

ASIAN NETWORK FOR
SCHIZOPHRENIA
RESEARCH

Final Programme

accredited by the European Council for Continuing Education
(EACCME) with 16 CME credits

TABLE OF CONTENT

	Page
Welcome Address.....	3
Conference Organisation.....	5
Conference Information.....	6
Format Descriptions /CME Credits.....	8
Opening Ceremony and Welcome Reception.....	10
Overview Scientific Programme.....	11
Scientific Programme	
Thursday, 26 September.....	14
Friday, 27 September.....	24
Saturday, 28 September.....	39
Acknowledgements.....	49
Floorplan.....	49
Index Chairpersons, Authors and Presenters.....	51



Dear Colleagues,

In recent years a growing body of cutting-edge schizophrenia research was performed and new evidence was generated with regard to aetiology, symptomatology, treatment and care of schizophrenia. Treatment research on new pharmacological targets and novel mechanisms of action demonstrated encouraging efficacy across a range of symptoms allowing for a better and personalised treatment. New imaging techniques were developed to gain new insights in the pathophysiology of this disorder. Some recent findings may help to diagnose schizophrenia earlier in the course and to predict treatment response. Yet we are still far away from understanding the underlying causes and complexity of schizophrenia corresponding to heterogeneous patient needs. Publication of the fifth edition of the Diagnostic and Statistical Manual of Mental Disorders (DSM-5) earlier this year has led to an intense and controversial discussion beyond the psychiatric community becoming a matter of public interest and media coverage.

The scientific programme of the European Conference on Schizophrenia Research (ECSR) critically discusses recent scientific advances, deals with current controversies, and updates the scientific knowledge about schizophrenia and translate it into clinical practice. The need to have a forum for scientific exchange and to address clinical challenges encouraged, in 2007, the Competence Network on Schizophrenia to initiate this biennial European schizophrenia congress which will be held for the fourth time.

According to this year's motto "[Together for better treatment and care](#)", the scientific programme of the ECSR provides a comprehensive overview on recent research projects and developments in schizophrenia treatment and documents the broad range of topics to be presented in plenary lectures, (prearranged and submitted) symposia, workshops, oral presentations and poster sessions. Treatment of negative symptoms, deficits in social cognition, non-adherence, and the promotion and implementation of evidence-based strategies to ensure standards of care as well as basic research topics will be addressed by high quality contributions from acknowledged experts, young scientists, and clinicians.

WELCOME ADDRESS

As in previous years, the co-organising psychiatric associations and their respective schizophrenia sections play an important role in this joint thematic conference. On occasion of the third ECSR the European Scientific Association on Schizophrenia and other Psychoses (ESAS) took over the responsibility to organise future ECSRs. Yet, the tasks of ESAS are certainly not limited to organising this conference; further tasks may be the identification of emerging issues for schizophrenia research and, as a consequence, outlining a research agenda and initiation of collaborations and networking activities.

On behalf of the Scientific Committee and the organisers, I cordially welcome you at the 4th European Schizophrenia Research Conference and thank you for your attendance. I wish all of us inspiring days.

Sincerely yours,



Wolfgang Gaebel
Congress President
President European Scientific Association
on Schizophrenia and other Psychoses
Speaker of the Competence Network on Schizophrenia

ORGANISERS



European Scientific Association
on Schizophrenia and other
Psychoses (ESAS)



Competence Network on
Schizophrenia (CNS)



European Psychiatric
Association (EPA) and its
Section on Schizophrenia



German Association for
Psychiatry, Psychotherapy
and Psychosomatics (DGPPN)

CO-SPONSORS



World Psychiatric Association
(WPA) and its Section
on Schizophrenia



Asian Network for
Schizophrenia Research (ANSR)

LOCAL ORGANISER

PsychoseNetz e.V.
Wolfgang Gaebel, Wolfgang Wölwer,
Viktoria Toeller
c/o Department of Psychiatry
and Psychotherapy
Heinrich-Heine-University Düsseldorf
LVR Clinic Center
Bergische Landstraße 2
40629 Düsseldorf, Germany

SCIENTIFIC SECRETARIAT

European Scientific Association on Schizophrenia
and other Psychoses (ESAS) e.V.
Wolfgang Gaebel, Wolfgang Wölwer,
Viktoria Toeller
c/o Department of Psychiatry and Psychotherapy
Heinrich-Heine-University Düsseldorf, Germany

PROFESSIONAL CONFERENCE ORGANISER

Hanser & Co GmbH
Postfach 12 21
22882 Barsbüttel, Germany
Phone: +49 – 40 – 670 88 20
Fax: +49 – 40 – 670 32 83
Email: schizophrenia@cpo-hanser.de

SCIENTIFIC PROGRAMME COMMITTEE

Wolfgang Gaebel, Germany
Congress President

George Awad, Canada
Finn Bengtsson, Sweden
Dinesh Bhugra, UK
Gerd Buchkremer, Germany
George Christodoulou, Greece
Peter Falkai, Germany
Silvana Galderisi, Italy
Wagner F. Gattaz, Brazil
Birte Glenthøj, Denmark
Philippe Gorwood, France
Heinz Häfner, Germany
Cyril Höschl, Czech Republic
Joachim Klosterkötter, Germany
Valery Krasnov, Russia
Shôn Lewis, UK
Jan Libiger, Czech Republic
Wolfgang Maier, Germany
Mario Maj, Italy
Stephen Marder, USA
Patrick McGorry, Australia
Hans-Jürgen Möller, Germany
Merete Nordentoft, Denmark
Michael Owen, UK
Victor Peralta, Spain
Wulf Rössler, Switzerland
Pedro Ruiz, USA
Bernard Sabbe, Belgium
Norman Sartorius, Switzerland
Frank Schneider, Germany
Wolfgang Wölwer, Germany
Til Wykes, UK

CONFERENCE INFORMATION

CONFERENCE VENUE

Urania Berlin e.V.
An der Urania 17
10787 Berlin, Germany
www.urania.de

CONFERENCE REGISTRATION COUNTER

All conference material and documentation are available at the conference registration counter located in the foyer on the ground floor of the Urania.

OPENING HOURS

Thursday, 26 Sept. 2013	08.00 – 18.00 h
Friday, 27 Sept. 2013	08.00 – 19.45 h
Saturday, 28 Sept. 2013	08.00 – 16.00 h

During these opening hours the conference counter can be reached at:
Phone: +49 – 30 – 2100 81 63

REGISTRATION FEE

ON-SITE REGISTRATION

Members of ESAS, CNS, EPA, DGPPN, WPA	EUR 490,00
Non-members	EUR 540,00
Trainees *	EUR 440,00

* Non-tenured junior scientists or clinical residents in training under 35 years (Trainee status must be confirmed by a certificate in writing by head of department and copy of passport).

ON-SITE REGISTRATION

On-site registration will be processed on a first-come, first-served basis. Priority will be given to pre-registered delegates. Depending on the number of on-site registered delegates, availability of conference documentation may be limited.

NAME BADGES

Participants are kindly requested to wear their name badge at all times during the conference including the Opening Ceremony and Welcome Reception.

CONFERENCE LANGUAGE

The conference language is English. Simultaneous translation will not be provided.

PROGRAMME CHANGES

The organisers cannot assume liability for any changes in the conference programme due to external or unforeseen circumstances.

CERTIFICATE OF ATTENDANCE

A certificate of attendance will be handed out upon demand at the registration counter.

ABSTRACT BOOK

All accepted abstracts are published in an abstract book as a supplement of the European Archives of Psychiatry and Clinical Neurosciences (EAPCN). The abstract book will be handed out together with the conference documentation at the registration counter.

MEDIA CHECK

The Media Check is located in hall Keppler on the first floor of the Urania. Speakers are asked to hand in their CD ROM or USB stick, containing the PowerPoint presentation (IBM format or compatible, no multisession) preferably one day before their session but at the latest 90 minutes prior to the presentation. The presentation will be transferred to a special conference notebook in the hall of the presentation. Due to time and technical reasons we kindly ask the speakers not to use their own notebook.

OPENING HOURS

Thursday, 26 Sept. 2013	08.00 – 18.00 h
Friday, 27 Sept. 2013	08.00 – 19.00 h
Saturday, 28 Sept. 2013	08.00 – 15.00 h

POSTER EXHIBITION

The poster exhibition is located in the foyers on the ground floor of the Urania. Posters will be on display for the entire time of the conference. They will be sorted by topics and will be numbered within those topics.

The poster exhibition is open to all registered delegates, daily guided poster tours will take place chaired by senior scientists:

Thursday, 26 Sept. 2013

Guided Poster Tours P-01 – P-04: 13.30 – 14.30 h

Friday, 27 Sept. 2013

Guided Poster Tours P-05 – P-09: 13.30 – 14.30 h

Saturday, 28 Sept. 2013

Guided Poster Tours P-10 – P-13: 13.30 – 14.30 h

Interested participants can meet the authors for discussions of their poster presentation during the time of the poster tour.

Set-up and dismantling times for posters

Set-up:

Thursday, 26 Sept. 2013: 08.00 – 10.00 h

Dismantling:

Saturday, 28 Sept. 2013: 16.00 – 17.00 h

Posters which have not been removed within the indicated dismantling time will be disposed.

COFFEE BREAKS

Coffee, tea and mineral water will be served free of charge to all registered delegates during the morning and afternoon coffee breaks from Thursday, 26 September to Saturday, 28 September 2013. Coffee bar stations are located on the first floor and in the foyer of the ground floor next to the poster exhibition.

LUNCH AND RESTAURANTS

A lunch snack will be served to all registered delegates during the lunch breaks from Thursday, 26 September to Saturday, 28 September 2013 in

the foyer of the ground floor next to the poster exhibition and on the first level. The conference venue further provides a restaurant on the first floor where snacks and food are available on cash basis.

MOBILE PHONES

Participants are kindly requested to keep their mobile phones turned off while attending the scientific sessions in the meeting rooms.

INSURANCE

The conference fee does not include insurance. All participants are advised to arrange for their own insurance. Health and accident insurance is recommended and has to be purchased in your country of residence.

HOW TO GET TO THE URANIA:

By plane

The congress venue Urania is just 8 km from Tegel airport and 22 km from Schönefeld airport.

By train

Centrally located within the heart of Berlin close to Tiergarten and Lützowplatz, the Urania is just 5 km from Berlin's main train station, and only a few minutes by car or taxi.

By car

Access to Berlin via the motorways A111, A113 or A115 with direction to Tiergarten / Lützowplatz. The Urania is located in the street "At the Urania", crossed by the Kurfürstenstrasse.

By public transportation

The Urania is well connected within the public transport network via U-Bahn lines 1, 2, 3 and 4 at the Wittenbergplatz and Nollendorfplatz U-Bahn stations, as well as via bus lines.

PARKING

The Urania provides 40 parking places free of charge in the courtyard.

The scientific programme will comprise the following formats:

PLENARY LECTURES

Invited lectures of 45 min each, covering current hot spots in schizophrenia research and given by leading European experts.

SYMPOSIA

Pre-arranged or submitted symposia of 90 min each, including four presentations and 15 min time for discussion covering major topics of the conference. Both symposia with a clear scientific focus and those with a clear clinical focus will be included.

WORKSHOPS

Pre-arranged workshops allowing for detailed discussion on scientific topics in particular serving transnational collaboration within Europe. Participation is included in the registration fee. For W-01 and W-02 preliminary registration is required.

ORAL PRESENTATION SESSIONS

Submitted presentations grouped by topics into thematic oral sessions of 90 min, including six or seven papers each.

POSTER SESSIONS

Submitted presentations grouped by topics into thematic guided poster sessions.

CME ACCREDITATION

The 'European Scientific Association on Schizophrenia and other Psychoses (ESAS)' is accredited by the European Accreditation Council for Continuing Medical Education (EACCME) to provide the following CME activity for medical specialists. The EACCME is an institution of the European Union of Medical Specialists (UEMS).

www.uems.net

The '4th European Conference on Schizophrenia Research (ECSR)' is designated for a maximum of **16 hours** of European external CME credits. Each medical specialist should claim only those hours of credit that he/she actually spent in the educational activity.

Through an agreement between the European Union of Medical Specialists and the American Medical Association, physicians may convert EACCME credits to an equivalent number of AMA PRA Category 1 Credits™. Information on the process to convert EACCME credit to AMA credit can be found at

www.ama-assn.org/go/internationalcme.

Live educational activities, occurring outside of Canada, recognised by the UEMS-EACCME for EC-MEC credits are deemed to be Accredited Group Learning Activities (Section 1) as defined by the Maintenance of Certification Program of The Royal College of Physicians and Surgeons of Canada.



EUROPEAN PSYCHIATRIC ASSOCIATION

Submit Your Abstract
Abstract Submission Deadline:
1 October 2013

22nd EUROPEAN CONGRESS OF PSYCHIATRY

Munich, Germany 1-4 March 2014

EUROPEAN PSYCHIATRY FOCUSING ON BODY AND MIND



Scan this code with your smart phone
www.epa-congress.org
Need a code reader for your phone?
<http://get.neoreader.com>

www.epa-congress.org

THURSDAY, 26 SEPTEMBER 2013

Opening Ceremony

09.15 – 10.15 h

Humboldt Hall

► Presidential Address

Professor Wolfgang Gaebel, Düsseldorf Germany
Congress President, Chair of the European Scientific Association on Schizophrenia and other Psychoses (ESAS), Speaker of the Competence Network on Schizophrenia (CNS)

► Welcome Addresses

Professor Danuta Wasserman, Stockholm, Sweden
President of the European Psychiatric Association (EPA)

Professor Wolfgang Maier, Bonn, Germany
President of the German Association for Psychiatry, Psychotherapy and Psychosomatics (DGPPN)

Professor Tarek Okasha, Cairo, Egypt
Secretary for Scientific Meetings of the World Psychiatric Association (WPA)

Professor Andi Jayalangkara Tanra, Makassar, Indonesia
President of the Asian College for Schizophrenia Research (ACSR)

► Aretaeus-Award Ceremony – Laureate 2013

Welcome Reception

19.00 – 20.00 h

Foyers

At the end of the scientific sessions participants are invited to join the Welcome Reception in the foyers of the first level of the Urania. Finger food and drinks will be provided.

Room	Humboldt	Kleist	Loft A	Einstein	Loft C	Foyer
Time						
09.15 – 10.15	Opening Ceremony					Registration Counter Opening Hours: 08.00 – 18.00
10.15 – 11.00	PL-01 Toward new approaches to classifying psychotic spectrum disorders: the NIMH Research Domain Criteria Project					
	Coffee Break					
11.30 – 13.00	S-01 Beyond DSM-5 and ICD-11: how should psychotic disorders be conceptualized and diagnosed in the future?	S-02 Preventive outpatient treatment approaches for schizophrenia-associated violence and delinquency	S-03 Apathy in schizophrenia – clinical, experimental and therapeutic approaches	S-04 The mild encephalitis hypothesis of schizophrenia updated: low level neuroinflammation, autoimmunity, volume transmission, treatment approaches		
13.00 – 14.30	Lunch Break 13.30 – 14.30 h ► Guided Poster Tours P-01 to P-04 P-01: Treatment (drug) 1 P-02: Neuropsychology 1 P-03: Comorbidity and psychopathology P-04: Course and outcome					
14.30 – 16.00	S-05 Approaches for predicting development of psychosis	S-06 The risks and benefits of antipsychotic polypharmacy: clinical relevance and development of evidence	S-07 Dimensional concepts of psychosis	O-01 Neurobiology	W-01: Part 1 How to write manuscripts for publication in English language scientific journals	
	Coffee Break					
16.30 – 18.00	S-08 Biological pathways to psychosis: the role of stress	S-09 Suicide prevention in schizophrenia	S-10 Eye movement research: a window to cognitive impairments in schizophrenia?	S-11 Microglia in schizophrenia	W-01: Part 2 How to write manuscripts for publication in English language scientific journals	
18.15 – 19.00	PL-02 Shifting paradigms for therapeutic discovery					
19.00 – 20.00	Welcome Reception					

Room	Humboldt	Kleist	Loft A	Einstein	Loft C	Foyer
Time						
08.30 – 10.00	S-12 Negative symptoms – impact and therapeutic options	S-13 Progression in brain tissue loss, antipsychotic medication, cognition and outcomes in schizophrenia – the Northern Finland 1966 Birth Cohort Study	S-14 Translational genetics for psychiatric illnesses	O-02 Neuropsychology		Registration Counter Opening Hours: 08.00 – 19.45
	Coffee Break					
10.30 – 12.00	S-15 The future of psychopathology in the light of current neuroscience	S-16 New approaches to cognitive behavior therapy for psychosis	S-17 Epigenetic dysregulation in schizophrenia	O-03 Functional Neuroimaging		
12.15 – 13.00	PL-03 Structure and function of the human brain at the level of receptors and neural systems: a basis for psychiatric research					
13.00 – 14.30	Lunch Break 13.30 – 14.30 h ► Guided Poster Tours P-05 to P-09 P-05: Neurobiology and genetics P-06: Functional neuroimaging P-07: Research methods and health service research P-08: Neuropsychology 2 P-09: Treatment 2					
14.30 – 16.00	S-22 From structure to functioning: neurobiological candidates for the prediction of psychoses	S-19 Should continuous antipsychotic medication be recommended after first episode psychosis?	S-20 The role of neuroinflammation in schizophrenia	S-21 Experimental psychopathology of psychosis	W-02: Part 1 How to apply for EU-funding	
	Coffee Break					
16.30 – 18.00	S-18 Perspectives in schizophrenia research: emerging research issues	S-23 Implementation of early intervention services for young people with first episode psychosis: rationale, evidence and practical experiences from Europe	S-24 Studies using structural and functional neuroimaging to advance understanding of schizophrenia	O-04 Comorbidity	W-02: Part 2 How to apply for EU-funding	
	Break					
18.15 – 19.45	S-25 Nosology in the schizophrenic psychoses: new insight from functional neuroimaging and genetics	S-26 The consequences of childhood trauma in psychotic disorders	S-27 Progress in neuropathological post-mortem findings in schizophrenia	O-05 Course and outcome		

Room Time	Humboldt	Kleist	Loft A	Einstein	Loft C	Foyer
08.30 – 10.00	S-28 The high risk state for psychosis	S-29 The role of oligodendrocytes in schizophrenia: disease-inherent versus treatment-induced abnormalities	S-30 Oscillations and synchrony in cortical networks in schizophrenia	O-06 Treatment		Registration Counter Opening Hours: 08.00 – 16.00
	Coffee Break					
10.30 – 12.00	S-31 Indicated prevention of psychosis	W-03 International perspectives of quality of care and integration of persons with schizophrenia	S-32 Single symptom approaches in schizophrenia: neuronal correlates of auditory hallucinations and language related symptoms	S-33 The schizophrenia motor dimension: clinical relevance and neurobiology		
12.15 – 13.00	PL-04 Twenty years of early intervention in psychosis: how critical is the critical period hypothesis?					
13.00 – 14.30	Lunch Break 13.30 – 14.30 h ► Guided Poster Tours P-10 to P-13 P-10: Treatment (psychosocial) 3 P-11: Risk states P-12: Structural neuroimaging P-13: Neuropsychology 3					
14.30 – 16.00	S-34 Obsessive-compulsive symptoms in schizophrenia	S-35 Psychological treatments for people with schizophrenia	S-36 Animal models of schizophrenia facing the complexity of genotype, environmental factors and phenotype	O-07 Structural neuroimaging		

PL-Plenary Lecture

S-Symposium

W-Workshop

O-Oral Presentation

P-Poster

PL-01	PLENARY LECTURES
10.15 – 11.00 h	Humboldt Hall
Toward new approaches to classifying psychotic spectrum disorders: the NIMH Research Domain Criteria Project	
<i>Chair: S. Galderisi, Naples, Italy</i>	

PL-01-001

Toward new approaches to classifying psychotic spectrum disorders: the NIMH Research Domain Criteria Project

B. N. Cuthbert, Bethesda, USA

S-01	SYMPOSIA
11.30 – 13.00 h	Humboldt Hall
Beyond DSM-5 and ICD-11: how should psychotic disorders be conceptualized and diagnosed in the future?	
<i>Chairs: A. Heinz, Berlin, Germany</i>	
<i>W. Gaebel, Düsseldorf, Germany</i>	

S-01-001

Functional impairment – a mandatory criterion for mental disorders?

W. Gaebel, Düsseldorf, Germany

S-01-002

How to distinguish between symptoms of a mental disease and impairments of (social) functions

A. Heinz, Berlin, Germany

E. Friedel

S-01-003

Are there specific symptoms that guide schizophrenia diagnosis?

S. Galderisi, Naples, Italy

S-01-004

Can key symptoms of schizophrenia be matched to brain systems?

W. Strik, Bern, Switzerland

T. Dierks

S-02	SYMPOSIA
11.30 – 13.00 h	Kleist Hall
Preventive outpatient treatment approaches for schizophrenia-associated violence and delinquency	
<i>Chairs: C. Luckhaus, Düsseldorf, Germany</i>	
<i>S. Hodgins, Montreal, Canada</i>	

S-02-001

The multifactorial basis of violence in schizophrenia

S. Hodgins, Montreal, Canada

S-02-002

A psychoeducational intervention programme to reduce compulsory hospital readmission in the Canton of Zurich

B. Lay, Zurich, Switzerland

T. Schönenberger, M. Bleiker, S. Lengler, C. Blank, W. Rössler

S-02-003

A preventive outpatient clinic for high-risk-of-violence patients in the region of Ansbach, Bavaria

J. Nitschke, Ansbach, Germany

C. Luckhaus

S-02-004

A complex-therapeutic intervention programme for schizophrenia outpatients targeted at reducing violent offending and compulsory detention in Düsseldorf, North Rhine-Westphalia

C. Luckhaus, Düsseldorf, Germany

S-03	SYMPOSIA
11.30 – 13.00 h	Loft A
Apathy in schizophrenia – clinical, experimental and therapeutic approaches	
<i>Chairs: S. Kaiser, Zurich, Switzerland</i>	
<i>A. Aleman, Groningen, The Netherlands</i>	

S-03-001

Apathy in first episode psychosis: similarities and differences to other brain disorders

A. Faerden, Oslo, Norway

S-03-002

Apathy as a disturbance of motivational and cognitive processes subserving goal-directed behavior

S. Kaiser, Zurich, Switzerland

S-03-003

Role of frontostriatal and frontoparietal networks in apathy

A. Aleman, Groningen, The Netherlands

S-03-004

Bilateral repetitive transcranial magnetic stimulation for negative symptoms of schizophrenia: findings from a double-blind randomized controlled trial

J. Dlabac-De Lange, Groningen, The Netherlands

L. Bais, A. Aleman, H. Knegtering

S-04	SYMPOSIA
11.30 – 13.00 h	Einstein Hall
The mild encephalitis hypothesis of schizophrenia updated: low level neuro-inflammation, autoimmunity, volume transmission, treatment approaches	
<i>Chairs: K. Bechter, Guenzburg, Germany</i>	
<i>B. Lennox, Oxford, United Kingdom</i>	

S-04-001

Antiinflammation and psychoimmunomodulation in schizophrenia

E. Weidinger, Munich, Germany

N. Müller

S-04-002

Autoimmunity to NMDA receptors in schizophrenia

B. Lennox, Oxford, United Kingdom

S-04-003

Volume transmission balancing wiring (e.g. synaptic) transmission

D. Borroto-Escuela, Stockholm, Sweden

K. Fuxe

S-04-004

The mild encephalitis hypothesis of schizophrenia updated

K. Bechter, Guenzburg, Germany

P-01	POSTER SESSIONS
13.30 – 14.30 h	Foyer
Treatment (drug) 1	
Chair: W. Fleischhacker, Innsbruck, Austria	

P-01-001

Bupropion treatment in schizophrenia: Risks and benefits according to the current literature

S. Englisch, Mannheim, Germany

K. Morgen, A. Meyer-Lindenberg, M. Zink

P-01-002

Mirtazapine treatment in schizophrenia: evidences derived from the current literature

S. Englisch, Mannheim, Germany

F. Afflerbach, M. Zink

P-01-003

2-Bromoterguride – an antipsychotic drug?

J. Brosda, Berlin, Germany

R. Franke, H. Pertz, H. Fink

P-01-004

Use of long acting antipsychotic injections in the maintenance treatment of chronic schizophrenia

E. Gemma, Terrassa, Spain

M. A. Gloria, R. Guillamat, M. Maria, A. M. Fargas

P-01-005

Effect of first and second generation antipsychotics on face affect expression in German and Chilean patients with schizophrenia

V. W. Larach, Santiago, Chile

A. Gazmair, L. F. Varela Espinoza, W. Wölwer, W. Gaebel

P-01-006

Adverse metabolic effects associated with use of long acting antipsychotic injections in the maintenance treatment of chronic schizophrenia

M. Gloria, Barcelona, Spain

G. Español, V. Valles, M. Montoro, A. M. Fargas

P-01-008

Descriptive analysis of schizophrenic patients in regular control in an atypical antipsychotic program in Chile

A. Armijo, Santiago, Chile

J. Villarroel, F. Valenzuela, D. Castillo, H. Silva

P-01-009

Prediction of antipsychotic therapy results basing on GSTM1 gene polymorphism in schizophrenic patients with different admission rate

V. Obyedkov, Minsk, Belarus

O. Skugarevsky, I. Halayenka

P-01-010

DTNBP1, HSPs and TAAR6 variations influence schizophrenic phenotype and treatment response

T.-Y. Jun, Seoul, Republic of Korea

C.-U. Pae

P-01-011

Neuroleptic malignant syndrome and swan neck deformity

E. Neroutsos, Elefsina-Athens, Greece

A. Graikiotis, J. Ntamos, M. Fiste, N. Lytra, E. Thermou

P-02	POSTER SESSIONS
13.30 – 14.30 h	Foyer
Neuropsychology 1	
<i>Chair: M. Green, Sydney, Australia</i>	

P-02-001

Anticipation and recall of emotions in subclinical negative symptoms – an experimental study in a social context

*M. Engel, Hamburg, Germany
T. M. Lincoln, A. Fritzsche*

P-02-003

Different strategies of schizophrenia patients in the visual exploration of social stimuli

*K. Drusch, Düsseldorf, Germany
S. Stroth, D. Kamp, H. Sievering, N. Raths, C. Schmitz, B. Derntl, W. Wölwer*

P-02-004

Neurophysiological correlates of defective emotional processing in schizophrenic patients with chronic auditory hallucinations

*E. Grasa, Barcelona, Spain
M. Rabella, S. Martínez-Horta, R. Fernández de Bobadilla, I. Corripio, A. Keymer, F. Artigas, J. Sanjuán, V. Pérez, J. Riba*

P-02-005

Neural underpinnings of inhibitory control in schizophrenia patients with a history of violence: a high-density electrical mapping study

*G. Andrade, Bronx, New York, USA
J. Butler, M. Krakowski, J. Foxe, P. De Sanctis*

P-02-006

Early sensory-perceptual contributions to emotional processing deficits in schizophrenia patients with a history of violent behavior

*W. Ritter, New York, USA
P. De Sanctis, G. N. Andrade, J. S. Butler, M. I. Krakowski, J. J. Foxe*

P-02-007

Affectively valenced stimuli modulate different processing stages of the inhibitory control circuit in schizophrenia patients with and without a history of violence

*P. De Sanctis, New York, USA
J. J. Foxe, G. N. Andrade, P. Czobor, M. I. Krakowski*

P-02-008

Metacognitive beliefs and thought control strategies in early psychosis

*T. Østefjells, Oslo, Norway
R. Hagen, J. I. Røssberg*

P-02-010

The integration of evidence is associated with neurocognitive capabilities in schizophrenia

*S. Eifler, Mannheim, Germany
F. Rausch, F. Schirmbeck, R. Veckenstedt, D. Mier, C. Esslinger, S. Englisch, A. Meyer-Lindenberg, P. Kirsch, M. Zink*

P-02-011

Interpersonal decentering in patients with schizophrenia

*K. Hosakova, Bilovec, Czech Republic
M. Lecbych*

P-03	POSTER SESSIONS
13.30 – 14.30 h	Foyer
Comorbidity and psychopathology	
Chair: W. Strik, Bern, Switzerland	

P-03-001

Immigrants do not show a specific psychosis symptom profile using a cross-culturally validated model of the PANSS

A. Berg, Oslo, Norway

I. Melle, S. R. Aminoff, K. L. Romm, O. Andreassen, E. Hauff

P-03-002

Family factor of adaptation of patients with schizophrenic disorders

E. Gutkevich, Tomsk, Russia

O. Danilenko, M. Zinchuk, A. Semke

P-03-003

Family assessment among patients with various mental disorders

H. Sadek, Cairo, Egypt

S. Rabei

P-03-004

Clinical–dynamic characteristics of schizophrenia associated with somatic pathology

V. Lebedeva, Tomsk, Russia

A. Semke, E. Yurovskaya

P-03-005

Alexithymia is associated with psychotic and hypomanic symptoms

M. Joukamaa, Tampere, Finland

S. Luutonen, R. K. Salokangas

P-03-006

Megalomania in dementia paralytica

I. Daey Ouwens, Venray, The Netherlands

E. Lens, A. Ott, P. Koehler, W. Verhoeven

P-03-007

Schizophrenia-like psychosis and concurrent Substance Abuse: descriptive analysis and phenomenological approach in a Colombian inpatient early phase rehabilitation program

P. Zuleta, Bogotá, Colombia

C. Rodríguez, G. Oviedo, F. Muñoz, J. Navarro

P-03-008

Alcohol use in schizophrenic patients

M. Del Carmen García Mahía, A Coruña, Spain

E. Roman Fernandez, M. Vidal Millares

P-03-010

Prevalence of risk factors in homicidal behavior in schizophrenic patients

I. Aliko, Tirane, Albania

A. Kazaferi

P-04	POSTER SESSIONS
13.30 – 14.30 h	Foyer
Course and outcome	
<i>Chair: to be announced</i>	

P-04-001

Duration of untreated psychosis in patients with a first episode psychosis in a high-income-versus a low- and middle income-region

N. Mossaheb, Vienna, Austria

M. Schloegelhofer, R. Kaufmann, S. Werneck-Rohrer, S. Zehetmayer, F. Malik, R. Khawar, H. R. Chaudhry, G. P. Amminger, C. Klier, H. Aschauer

P-04-002

Characteristics of illnesses and their course within the „psychotic continuum“ – predictive value for current psychopathology, cognition and functional outcome

J. Hallaschek, Halle, Germany

S. Watzke

P-04-003

Metacognition and negative symptoms in first episode psychosis: cross-sectional and longitudinal findings

A. Macbeth, Elgin, United Kingdom

H. McLeod, A. Gumley, M. Schwannauer, P. Lysaker, G. Dimaggio

P-04-004

Comparative of adolescent and adult onset psychosis: one year follow up

M. Dolz, Esplugues de Llobregat (BCN), Spain

J. Tor, J. Carlson, B. Sánchez, M. Pardo, D. Muñoz, A. Barajas, I. Baños, J. Usall, S. Ochoa

P-04-006

Factors affecting health related quality of life in psychiatric inpatients during treatment

G. Lyrakos, Nikaia, Greece

V. Spinaris, I. Spyropoulos

P-04-008

High religiousness, less perspective-taking and social suffering distinguish stable schizophrenia patients

R. Duñó, Sabadell, Spain

S. Díaz-Morán, A. Tobeña

P-04-010

Schizophrenia with obsessive-compulsive disorder comorbidity – clinical and treatment particularities

A. Ciobanu, Bucharest, Romania

S-05	SYMPOSIA
14.30 – 16.00 h	Humboldt Hall
Approaches for predicting development of psychosis	
Organised by the Competence Network on Schizophrenia (CNS)	
Chairs: M. Marshall, Manchester, United Kingdom	
J. Klosterkötter, Cologne, Germany	

S-05-001

Prognostic and therapeutic validity of the Attenuated Psychosis Syndrome

P. Fusar-Poli, London, United Kingdom

S-05-002

The epidemiologic perspective of risk identification and psychosis prediction

I. Kelleher, Dublin, Ireland

A. Murtagh, C. Molloy, S. Roddy, M.C. Clark, M. Harley, M. Cannon

S-05-003

Predicting psychosis in clinical practice—outcome of patients seen in a NHS Prodrome Clinic

M. Marshall, Manchester, United Kingdom

C. Johnson, K. Neelam, R. Drake

S-05-004

How to improve the prediction of psychosis

S. Ruhrmann, Cologne, Germany

S-06	SYMPOSIA
14.30 – 16.00 h	Kleist Hall
The risks and benefits of antipsychotic polypharmacy: clinical relevance and development of evidence	
Chairs: J. Cordes, Düsseldorf, Germany	
W. Fleischhacker, Innsbruck, Austria	

S-06-001

Antipsychotic drug target occupancy in PET studies: lessons for combining antipsychotics?

G. Gründer, Aachen, Germany

S-06-002

When to switch or combine: time course for response in antipsychotic drug treatment

M. Jäger, Guenzburg, Germany

S-06-003

The development of multiple antipsychotic combination treatment in comparison between European countries – findings from the AMSP project

A. Konstantinidis, Vienna, Austria

J. Cordes, D. Degner, T. Schuhmann, S. Kasper

S-06-004

A RCT to assess the benefits of Olanzapine and Amisulpride combination treatment (COMBINE): design and methods

C. Schmidt-Kraepelin, Düsseldorf, Germany

S-07	SYMPOSIA
14.30 – 16.00 h	Loft A
Dimensional concepts of psychosis	
<i>Chairs: W. Strik, Bern, Switzerland</i>	
<i>A. Heinz, Berlin, Germany</i>	

S-07-001

Dimensions of psychotic symptoms and brain physiology

W. Strik, Bern, Switzerland

S. Walther, A. Wopfner, K. Stegmayer, D. Hubl, H. Horn, T. Dierks

S-07-002

Thought and language disorders in psychosis

T. Kircher, Marburg, Germany

S-07-003

Dysfunctions of the motor system in schizophrenia

S. Walther, Bern, Switzerland

S-07-004

The limbic system and positive symptoms of schizophrenia

A. Heinz, Berlin, Germany

W-01	WORKSHOPS
14.30 – 18.00 h	Loft C
How to write manuscripts for publication in English language scientific journals	
<i>Chair: S. Hodgins, Montreal, Canada</i>	

O-01	ORAL PRESENTATIONS
14.30 – 16.00 h	Einstein Hall
Neurobiology	
<i>Chair: A. Papassotiropoulos, Basel, Switzerland</i>	

O-01-001

Deviations of levels of serum auto-antibodies (a-Ab) to the antigens of nervous tissue in patients with schizophrenia: confirmation of the mild encephalitis hypothesis

V. Orlova, Moscow, Russia

I. Mikhailova, V. Minutko, N. Eliseeva, J. Kretova

O-01-002

Evaluation of a potential endophenotype marker in schizophrenia: a blunted niacin response

J. Yao, Pittsburgh, USA

G. Dougherty, G. Haas, R. Condray, E. Messamore

O-01-003

The role of agmatine in pathogenesis of schizophrenia

T. Uzbay, Istanbul, Turkey

H. Kayir

O-01-004

Reduced striatal adenosine A(2A) receptor levels define a molecular subgroup in schizophrenia

M. Barrachina, L'Hospitalet de Llobregat, Spain

I. Villar-Menéndez, S. Díaz-Sánchez, M. Blanch, J. L. Albasanz, T. Pereira-Veiga, A. Monje, L. M. Planchat, I. Ferrer, M. Martín

O-01-005

Correlative multiscale volume microscopy study of white matter cell structures in post-mortem samples of human brain

V. Shklover, Skolkovo, Odintsovsky District, Russia

N. Uranova, V. Chelpanov, A. Lavrenyuk, P. Kazanskiy

O-01-006

Impact of chronic nicotine treatment on Hippocampal Oscillatory Activity in a G72/30 transgenic mouse model for schizophrenia

A. Lundt, Bonn, Germany

B. Hambsch, D.-M. Otte, A. Papazoglou, H. Schrage, D. Mauer, R. Müller, K. Broich, A. Zimmer, M. Weiergräber

S-08	SYMPOSIA
16.30 – 18.00 h	Humboldt Hall
Biological pathways to psychosis: the role of stress	
<i>Chairs: D. Nordholm, Copenhagen, Denmark</i>	
<i>S. Wood, Birmingham, United Kingdom</i>	

S-08-001

Pituitary volume, cortisol and stress in healthy controls, ultra high-risk subjects and first episode psychosis subjects

D. Nordholm, Copenhagen, Denmark

E. Rostrup, L. Randers, M. O. Nielsen, H. Emig-Norbak,

V. Mondelli, P. Dazzan, M. Nordentoft, B. Glenthøj

S-08-002

The effect of stress and its biological mediators on the onset and clinical outcome of psychosis

V. Mondelli, London, United Kingdom

S-08-003

The effect of stress on cortical thickness, surface area and subcortical brain volume in first episode psychosis over the first 12 weeks of treatment

R. Reniers, Birmingham, United Kingdom

S-08-004

Effect of pre-exposure to chronic social stress on HPA axis and neurotoxicity in animal models of schizophrenia

D. Inta, Mannheim, Germany

D. Filipovic, P. Gass

PL-02	PLENARY LECTURES
18.15 – 19.00 h	Humboldt Hall
Shifting paradigms for therapeutic discovery	
<i>Chair: W. Gaebel, Düsseldorf, Germany</i>	

PL-02-001

Shifting paradigms for therapeutic discovery

W. T. Carpenter Jr., Baltimore, USA

S-09	SYMPOSIA
16.30 – 18.00 h	Kleist Hall
Suicide prevention in schizophrenia	
<i>Chairs: D. Wasserman, Stockholm, Sweden</i>	
<i>S. Galderisi, Naples, Italy</i>	

S-09-001

Epidemiology of suicide and attempted suicide in the population of schizophrenic patients

A. Schmidtke, Wuerzburg, Germany

D. Wasserman, B. Pfuhlmann, M. Sarchapione,

J. Maloney

S-09-002

Psychotic symptoms as a risk marker for suicidal behaviour

I. Kelleher, Dublin, Ireland

P. Corcoran, H. Keeley, J.T.W. Wigman, N. Devlin,

H. Ramsay, C. Wasserman, V. Carli, M. Sarchiapone,

C. Hoven, D. Wasserman, M. Cannon

S-09-003

Strategies and possibilities in suicide prevention

D. Wasserman, Stockholm, Sweden

S-09-004

Challenges in clinical practice: predicting, treating and rehabilitating suicidal schizophrenia patients

S. Galderisi, Naples, Italy

S-10	SYMPOSIA
16.30 – 18.00 h	Loft A
Eye movement research: a window to cognitive impairments in schizophrenia?	
<i>Chairs: W. Wölwer, Düsseldorf, Germany</i>	
<i>M. Boucart, Lille, France</i>	

S-10-001

Independence of smooth pursuit and visual scanpaths and a model of eye movement dysfunction in major mental illnesses

P. Benson, Aberdeen, United Kingdom

S. A. Beedie, E. Nouzová, D. St. Clair

S-10-002

The relationship between visual exploration and action processing in schizophrenia

M. Boucart, Lille, France

S-10-003

Gaze behavior in early states of psychosis

S. Ruhrmann, Cologne, Germany

A. Nikolaides, S. Miess, R. Müller, J. Klosterkötter

S-10-004

Concurrent assessment of eye movements and EEG in schizophrenia

S. Stroth, Düsseldorf, Germany

K. Drusch, D. Kamp, W. Wölwer

S-11	SYMPOSIA
16.30 – 18.00 h	Einstein Hall
Microglia in schizophrenia	
<i>Chairs: S. Wolf, Berlin, Germany</i>	
<i>P. Falkai, Munich, Germany</i>	

S-11-001

HLA-DR+ microglia are increased in paranoid schizophrenia versus residual schizophrenia: evidence from human postmortem studies

J. Steiner, Magdeburg, Germany

S. Busse, H.-G. Bernstein, B. Bogerts

S-11-002

Immunohistochemical investigations of microglia in schizophrenia

A. Schmitt, Munich, Germany

T. Bayer, P. Falkai

S-11-003

Microglia properties in schizophrenia

A. Friebe, Bochum, Germany

G. Juckel

S-11-004

Epigenetic changes in microglia derived from an animal model for schizophrenia

S. Wolf, Berlin, Germany

D. Mattei

S-12	SYMPOSIA
08.30 – 10.00 h	Humboldt Hall
Negative symptoms – impact and therapeutic options	
<i>Chairs: N. Sartorius, Geneva, Switzerland</i>	
<i>W. Gaebel, Düsseldorf, Germany</i>	

S-12-001

Negative symptoms in schizophrenia: prevalence and impact on functional outcome

S. Galderisi, Naples, Italy

S-12-002

Negative symptoms, culture and the stigma of schizophrenia

N. Sartorius, Geneva, Switzerland

S-12-003

Current therapeutical options and unmet needs in treating negative symptoms in schizophrenia

W. Gaebel, Düsseldorf, Germany

S-12-004

Future prospects in the treatment of schizophrenia negative symptoms

D. Bugarski-Kirola, Switzerland

S-13	SYMPOSIA
08.30 – 10.00 h	Kleist Hall
Progression in brain tissue loss, antipsychotic medication, cognition and outcomes in schizophrenia – the Northern Finland 1966 Birth Cohort Study	
<i>Chairs: J. Miettunen, Oulu, Finland</i>	
<i>M. Isohanni, Oulu, Finland</i>	

S-13-001

Outcomes of schizophrenia from a lifespan perspective – the Northern Finland 1966 Birth Cohort Study

M. Isohanni, Oulu, Finland

D. Cowling, P. Juola, J. Moilanen, A. Husa, M. Penttilä, S. Huhtaniska, J. Veijola, J. Miettunen, E. Jääskeläinen

S-13-002

Antipsychotic medication and longitudinal changes in brain volume in schizophrenia: meta-analysis and results from the Northern Finland 1966 Birth Cohort Study

J. Miettunen, Oulu, Finland

S. Huhtaniska, N. Hirvonen, J. Remes, G. Murray, J. Veijola, M. Isohanni, E. Jääskeläinen

S-13-003

Longitudinal association between antipsychotic medication and change of cognition in schizophrenia – the Northern Finland 1966 Birth Cohort Study

A. Husa, Oulu, Finland

J. Moilanen, I. Rannikko, M. Haapea, G. Murray, J. Barnett, P. Jones, M. Isohanni, H. Koponen, J. Miettunen, E. Jääskeläinen

S-13-004

Duration of untreated psychosis and outcomes and brain volume loss in schizophrenia – the Northern Finland 1966 Birth Cohort Study

M. Penttilä, Oulu, Finland

S-14	SYMPOSIA
08.30 – 10.00 h	Loft A
Translational genetics for psychiatric illnesses	
Organised by the German Association for Psychiatry, Psychotherapy and Psychosomatics (DGPPN)	
Chairs: <i>W. Maier, Bonn, Germany</i> <i>T. Schulze, Göttingen, Germany</i>	

S-14-001

Genetic mouse models of relevance to schizophrenia: converging neurobiological mechanisms?

J. A. Pratt, Glasgow, United Kingdom

S-14-002

The path to translating genetics into clinical psychiatry: a realistic assessment

T. Schulze, Göttingen, Germany

S-14-003

Rat models for cognition and cognitive deficits

D. Bartsch, Mannheim, Germany

S-14-004

The genetic basis of human memory and its relevance for neuropsychiatric disorders

A. Papassotiropoulos, Basel, Switzerland

O-02	ORAL PRESENTATIONS
08.30 – 10.00 h	Einstein Hall
Neuropsychology	
Chair: <i>W. Wölwer, Düsseldorf, Germany</i>	

O-02-001

Social motor coordination in schizophrenia patients: a new clinical perspective

D. Capdevielle, Montpellier, France

R. Salesse, J. Del-Monte, M. Varlet, L. Marin, R. Schmidt, B. Bardy, J.-P. Boulenger, S. Raffard

O-02-002

To trust or not to trust: the dynamics of social interactions in early psychosis

A.-K. Fett, Amsterdam, The Netherlands

S. S. Shergill, P. M. Gromann, D. W. Joyce, L. Krabbendam

O-02-003

Is the theory of mind deficit in schizophrenia explained by an impaired attention toward faces?

P. Roux, Paris, France

B. Forgeot d'Arc, C. Passerieux, F. Ramus

O-02-004

To see, or not to see: that is the question. The "Protection-Against-Schizophrenia" (PAS) model

S. Landgraf, Regensburg, Germany

O-02-005

Associations between metamemory and neurocognitive abilities in schizophrenia

S. Eifler, Mannheim, Germany

F. Rausch, F. Schirmbeck, V. Ruth, D. Mier, C. Esslinger, S. Englisch, A. Meyer-Lindenberg, P. Kirsch, M. Zink

O-02-006

The relationship between stress and cognitive performance in real life environments in patients with schizophrenia

B. Wright, London, United Kingdom

E. Peters, E. Kuipers, V. Kumari

S-15	SYMPOSIA
10.30 – 12.00 h	Humboldt Hall
The future of psychopathology in the light of current neuroscience	
<i>Chairs: O. Gruber, Göttingen, Germany</i>	
<i>W. Gaebel, Düsseldorf, Germany</i>	

S-15-001

RDoC and the future classification of schizophrenia spectrum disorders

B. N. Cuthbert, Bethesda, USA

S-15-002

Modular psychopathology and symptom dimensions in schizophrenia

W. Gaebel, Düsseldorf, Germany

S-15-003

Neuroimaging of symptoms and endophenotypic brain dysfunctions in schizophrenia: psychopatho(physio)logy of the future?

O. Gruber, Göttingen, Germany

S-15-004

Symptom dimensions and brain systems: their roles for understanding and treatment of schizophrenia spectrum disorders

W. Strik, Bern, Switzerland

J. Kindler, P. Homann, A. Wopfner, K. Stegmayer, H. Horn, T. Dierks

PL-03	PLENARY LECTURES
12.15 – 13.00 h	Humboldt Hall
Structure and function of the human brain at the level of receptors and neural systems: a basis for psychiatric research	
<i>Chair: W. Maier, Bonn, Germany (tbc)</i>	

PL-03-001

Structure and function of the human brain at the level of receptors and neural systems: a basis for psychiatric research

K. Zilles, Aachen, Germany

S-16	SYMPOSIA
10.30 – 12.00 h	Kleist Hall
New approaches to cognitive behavior therapy for psychosis	
<i>Chairs: T. Kircher, Marburg, Germany</i>	
<i>J. Klosterkötter, Cologne, Germany</i>	

S-16-001

Cognitive biases as moderators and mediators of successful CBTp

S. Mehl, Marburg, Germany

S-16-002

Psychotherapy in subjects at high mental risk state

A. Bechdolf, Berlin, Germany

S-16-003

How does CBT effect the brain of patients with schizophrenia: a multicenter fMRI study

A. Krug, Marburg, Germany

S-16-004

Who benefits and why? Predictors of change and drop-out during cognitive behavioural therapy for psychosis

T. Lincoln, Hamburg, Germany

S. Mehl, S. Westermann, M. Ziegler, M.-L. Kesting, E. Luellmann, W. Rief

S-17	SYMPOSIA
10.30 – 12.00 h	Loft A
Epigenetic dysregulation in schizophrenia	
<i>Chairs: P. Falkai, Munich, Germany</i>	
<i>A. Fischer, Göttingen, Germany</i>	

S-17-001

Cognitive symptoms in schizophrenia – pharmacological aspects of a core symptom domain
W. Fleischhacker, Innsbruck, Austria

S-17-002

Molecular basis of epigenetic regulation
A. Fischer, Göttingen, Germany

S-17-003

HDACi for the treatment of schizophrenia – pre-clinical and clinical aspects
A. Hasan, Munich, Germany

S-17-004

Epigenetic therapies in oncology – clinical and safety aspects
M. Bitzer, Tübingen, Germany

O-03	ORAL PRESENTATIONS
10.30 – 12.00 h	Einstein Hall
Functional neuroimaging	
<i>Chair: A. Aleman, Groningen, The Netherlands</i>	

O-03-001

Phenotyping schizophrenia by multi-modal brain imaging
U. Schall, Callagahn, Australia

O-03-002

Working memory dependent prefrontal-parietal connectivity and model-based diagnostic classification in schizophrenia
L. Deserno, Berlin, Germany
K. H. Brodersen, Z. Lin, W. D. Penny, A. Heinz, K. E. Stephan, F. Schlagenhauf

O-03-003

Shared brain phenotypes for working memory dysfunction among schizophrenia and bipolar disorder
M. Green, Sydney, Australia
Y. Quide, A. Shepherd, R. Morris, J. Rowland, P. Mitchell, V. Carr

O-03-004

Alterations in the theory of mind network in unaffected first-degree relatives of patients with schizophrenia
H. Walter, Berlin, Germany
S. Mohnke, S. Erk, N. Seiferth, O. Grimm, L. Haddad, K. Schnell, M. Nöthen, A. Heinz, A. Meyer-Lindenberg

O-03-005

Reduced activation in nucleus accumbens and ventral tegmental area during probabilistic decision-making in schizophrenia
F. Rausch, Mannheim, Germany
D. Mier, S. Eifler, C. Esslinger, C. Schilling, F. Schirmbeck, S. Englisch, A. Meyer-Lindenberg, P. Kirsch, M. Zink

O-03-006

Abnormal delta oscillatory activity during acute psychotic episode in schizophrenia: a MEG study
J. Tarrago, Barcelona, Spain
R. Novak, C. Alonso, O. Pino, E. Rojo

P-05	POSTER SESSIONS
13.30 – 14.30 h	Foyer
Neurobiology and genetics	
Chair: T. Schulze, Göttingen, Germany	

P-05-001

Glutamate concentrations and performance during operant conditioning in schizophrenia

T. Gleich, Berlin, Germany

R. Böhme, L. Deserno, A. Pankow, J. Gallinat, A. Heinz, F. Schlagenhauf

P-05-002

Altered adhesion and microfilament organization in neuronal precursors of schizophrenia patients: reversion by melatonin

G. Benítez-King, México-City, Mexico

H. Zamudio-Meza, T. Galvan-Arrieta, A. Riquelme, H. Solís-Chagoyan, J. Muñoz-Estrada, C. Berlanga, I. Meza

P-05-003

Neuropathological finding of frontal cortex of animal model and postmortem human brain of schizophrenia

S. Iritani, Nagoya, Japan

H. Sekiguchi, C. Habuchi, K. Umeda, Y. Torii, M. Miyata, K. Fujita, N. Ozaki

P-05-004

Molecular mechanisms of visual adaptation: a role for the DTNBP1 (Dysbindin) schizophrenia risk gene in visual short-term plasticity

G. Andrade, Bronx, New York, USA

J. Butler, B. Abrahams, J. Foxe

P-05-005

Expression of DISC1 in the development of the white matter of rats

C. Li, Chongqing, People's Republic of China

L. Xiao, S. Liu, M. Wei

P-05-006

Role of CB1 receptor and endocannabinoids on cortico-striatal connectivity of psychosocially stressed mice

U. Havemann-Reinecke, Göttingen, Germany

P-05-008

Concordance and heritability in schizophrenia, register-based data from a Danish twin study

R. Hilker, Glostrup, Denmark

M. Nordentoft, D. Helenius, B. Glenthøj

P-05-009

Acute intermittent porphyria and cycloid psychosis

I. Daey Ouwens, Venray, The Netherlands

P-05-010

Kallmann syndrome and schizophrenia: is there a relationship?

W. Verhoeven, Venray, The Netherlands

J. Egger, J. Hovens, N. De Leeuw, L. Hoefsloot

P-05-011

Routine screening for copy number variations in schizophrenia-spectrum disorders: relevant to clinical practice?

W. Verhoeven, Venray, The Netherlands

N. van de Kerkhof, I. Feenstra, F. van der Heijden,

N. de Leeuw, J. Egger, G. Stöber

P-06 POSTER SESSIONS

13.30 – 14.30 h Foyer

Functional neuroimaging

Chair: A. Heinz, Berlin, Germany

P-06-001

Altered reinforcement learning and working memory in psychosis

F. Schlagenhauf, Berlin, Germany

P-06-002

Reinforcement learning in an uncertain environment: behavioral and neural correlates in schizophrenia patients and healthy participants with delusional experiences

R. Boehme, Berlin, Germany

L. Deserno, T. Katthagen, A. Pankow, T. Gleich, A. Heinz, F. Schlagenhauf

P-06-003

Model-free and model-based control in reinforcement learning: relation to dopamine synthesis and implications for schizophrenia

L. Deserno, Berlin, Germany

R. Böhme, A. Wiltzki, R. Buchert, Q. Huys, S. Florian

P-06-004

Neural correlates of action and expected value during the anticipation of monetary reward

Y. Fukuda, Berlin, Germany

L. Deserno, S. Koch, F. Schlagenhauf

P-06-005

Aberrant brain reward response in siblings of patients with psychosis during trust-related behaviour

P. Gromann, Amsterdam, The Netherlands

S. Shergill, L. de Haan, D. Meewis, A.-K. Fett, L. Krabendam

P-06-006

Improvement of brain reward abnormalities related to Dopamine D2/D3 receptor blockade – a study in antipsychotic-naïve first-episode schizophrenia patients

S. Wulff, Glostrup, Denmark

M. Ø. Nielsen, E. Rostrup, B. Y. Glenthøj

P-06-007

Altered default mode network activity in schizophrenia patients

A. Pankow, Berlin, Germany

L. Deserno, F. Bermpohl, M. Walter, F. Schlagenhauf, A. Heinz

P-06-008

Self-reference processing in schizophrenia and psychotic experiences – an fMRI study

T. Katthagen, Berlin, Germany

A. Pankow, L. Deserno, M. Gaebler, A. Heinz, F. Schlagenhauf

P-06-009

Brief monocular deprivation as an assay of short-term visual sensory plasticity in schizophrenia – “the binocular effect”

J. Foxe, Bronx, USA

S. Yeap, V. Leavitt

P-06-010

Obsessive-compulsive symptoms in schizophrenia are associated with more activation of the orbito-frontal cortex

F. Schirmbeck, Mannheim, Germany

D. Mier, C. Esslinger, F. Rausch, S. Eifler, S. Englisch,

A. Meyer-Lindenberg, P. Kirsch, M. Zink

P-07	POSTER SESSIONS
13.30 – 14.30 h	Foyer
Research methods and health service research	
<i>Chair: to be announced</i>	

P-07-002

The early recognition inventory ERIraos detects at risk mental states of psychosis with high sensitivity

F. Rausch, Mannheim, Germany

S. Eifler, A. Esser, C. Esslinger, F. Schirmbeck, A. Meyer-Lindenberg, M. Zink

P-07-003

Assessment of prodromal symptoms in incipient psychotic disorders: reliability and validity measures of the Early Recognition Inventory-Spanish Version (ERIraos-SV)

S. Ochoa, Sant Boi de Llobregat, Spain

A. Barajas, A. Farreny, R. Rodriguez-Jimenez, M. Moreno, R. Landin-Romero, C. Bayon, A. Ibanez, B. Cabrera, M. A. Quintanilla, J. Usall

P-07-004

"It was easier than dealing with a pen and paper...": exploring the usability of electronic devices for completion of Clinical Outcome Assessments (COAs) in schizophrenia

C. Tolley, Bollington, UK

D. Rofail, A. Gater

P-07-005

When does "Yes" mean "Yes": is parental consent a necessary component of obtaining informed consent from minors in Canada's indigenous context

C. Cheng, Thunder Bay, Canada

J. Fogolin, M. Katt, S. Nadin, P. Braunberger, J. B. Minore, C. S. Dewa

P-07-007

Changing attitude towards schizophrenia by psychiatric training of medical students

F. Lang, Guenzburg, Germany

M. Kösters, S. Lang, T. Becker, M. Jäger

P-07-008

Assessment on the impact of financial crisis on the access to mental health services in Greece

E. Neroutsos, Elefsina-Athens, Greece

A. Pachi, M. Fiste, E. Kontomina, E. Bisbiki, N. Lytra

P-07-009

First Spanish virtual community for people who hear voices

M. J. Escartí Fabra, Valencia, Spain

E. Lorente Rovira, A. Luengo Martín, E. Aguilar, J. Sanjuán Arias

P-07-010

State and problems of psychiatric care in Kazakhstan (focus on schizophrenia)

S. Nurmagambetova, Almaty, Kazakhstan

M. Assimov

P-08 POSTER SESSIONS

13.30 – 14.30 h

Foyer

Neuropsychology 2

Chair: P. Ward, Liverpool, Australia

P-08-001

Cognitive impairments are linearly related to psychometric risk for schizophrenia-spectrum disorders

S. Giakoumaki, Rethymno, Greece

P. Roussos, C. Zourarakis, P. Bitsios

P-08-002

Is the tendency to extract meaning from auditory noise associated with schizotypy?

S. Morton, Dunedin, New Zealand

M. Nicolson, R. J. Linscott

P-08-003

Schizotypal traits in a community sample: characteristics and neuropsychological correlates

M. Tesse, London, United Kingdom

P-08-004

Schizotypal traits in a non-clinical population based sample: characteristics and neuropsychological performance profiles

M. Tesse, London, United Kingdom

P-08-005

Neurocognitive performance in treatment-resistant and non-treatment-resistant schizophrenia

V. Anderson, Auckland, New Zealand

M. McIlwain, C. McNabb, R. Kydd, B. Russell

P-08-006

Cognitive functioning in individuals aged >65 years with 'very-late-onset schizophrenia-like-psychosis' (VLOSLP), chronic schizophrenia and late-onset psychotic depression

S. Simpson, The Ponds, Australia

R. Langdon, J. Batchelor, A. Falcon, S. Tyagi

P-08-007

A comprehensive neuropsychological study of individuals with very-late-onset schizophrenia-like-psychosis

S. Simpson, The Ponds, Australia

R. Langdon, J. Batchelor, A. Falcon, S. Tyagi

P-08-008

The relationship between noise-induced stress and cognitive performance in patients with schizophrenia

B. Wright, London, United Kingdom

E. Peters, E. Kuipers, V. Kumari

P-08-009

The MATRICS Consensus Cognitive Battery (MCCB) in Norway: associations with IQ, clinical and occupational measures

J. Lystad, Oslo, Norway

E. Falkum, H. Bull, C. Mohn, B. Rishovd Rund, T. Ueland

P-08-010

The relation between insight and use of feedback on the Wisconsin Card Sorting Test in patients with schizophrenia

A. de Vos, Assen, The Netherlands

M. Pijnenborg, A. Aleman, L. van der Meer

P-08-011

Influence of gender on the primacy and recency effect in patients with a first-episode psychosis and schizophrenia patients

E. Huerta-Ramos, Sant Boi de Llobregat, Spain

A. Butjosa Molines, C. Núñez Leánez, J. Usall

i Rodiè, A. Barajas Vélez, A. Foix Sanjuan, M. Dolz

Abadia, S. Ochoa Güerre

P-08-013

Relation between jumping to conclusions (JTC) and neuropsychological performance

S. Ochoa, Sant Boi de Llobregat, Spain

C. Stephan-Otto, L. Nieto, J. Usall, J. Cuevas, E. Huerta-

Ramos, J. M. Haro, G. Brebion

P-09	POSTER SESSIONS
13.30 – 14.30 h	Foyer
Treatment 2	
Chair: G. Gründer, Aachen, Germany	

P-09-001

Sexual adverse effects and antipsychotic-induced hyperprolactinemia: a cross-sectional study

*J. Usall, Sant Boi de Llobregat, Spain
R. Cambra, E. Rubio-Abadal, G. Saenz Navarrete, B. Arranz, N. del Cacho, R. Iniesta, M. Roca, V. Barneda*

P-09-002

Sexual dysfunction in schizophrenic and schizoaffective patients treated with antipsychotics

*M. Del Carmen García Mahía, A Coruña, Spain
M. Vidal Millares, E. Roman Fernandez*

P-09-003

Psychiatric and non-psychiatric comorbidity in schizophrenic patients treated with antipsychotics

*M. Del Carmen García Mahía, A Coruña, Spain
M. Vidal Millares, J. A. Amado García*

P-09-004

Comparative assessment of the social performances for schizophrenic patients treated with long acting antipsychotics

*M. C. Pirlog, Craiova, Romania
I. Marinescu, D. Marinescu*

P-09-005

Antipsychotics and antidepressants and their associations with suicidal ideation – the Northern Finland Birth Cohort 1966 study

*I. Rissanen, Oulu, Finland
E. Jääskeläinen, M. Isohanni, H. Koponen, M. Joukamaa, A. Alaräisänen, J. Miettunen*

P-09-006

Involuntary hospitalization and the course of medication adherence, treatment engagement and perception of coercion

*S. Jaeger, Ravensburg, Germany
C. Pfiffner, P. Weiser, G. Längle, D. Croissant, W. Schepp, R. Kilian, T. Becker, G. Eschweiler, T. Steinert*

P-09-007

Long-term effects of prefrontal rTMS on cognitive functioning in schizophrenia

*C. Kos, Groningen, The Netherlands
J. Dlabac-de Lange, L. Bais, R. Knegtering, A. Aleman*

P-09-008

Trends in the administration of electroconvulsive therapy for schizophrenia in Colombia. Descriptive study and literature review

*G. Oviedo, Bogotá, Colombia
P. Zuleta, F. Muñoz, C. Torres, R. De la Espriella, D. Garzón, A. Daza, J. Carrillo*

P-09-009

Sleep prolongation may decrease level of self-reported sleepiness but not slow wave activity in electroencephalogram (EEG) in patients with schizophrenia

*M. Jarema, Warsaw, Poland
L. Okruszek, A. Wichniak, A. Wierzbicka, E. Walinowska, K. Czesak, I. Musinska, T. Jakubczyk, W. Jernajczyk M.D.*

P-09-010

Can work history at baseline predict work behavior within the first four weeks of vocational rehabilitation?

*H. Bull, Oslo, Norway
T. Ueland, J. Ullevoldsaeter Lystad, E. Falkum*



WWW.PSYCHIATRY-CONGRESS-BERLIN.ORG

PSYCHIATRY CONGRESS BERLIN

27–30 November 2013 | ICC Berlin | Germany

From Therapy to Prevention

SELECTION OF LECTURES

- What can Psychiatry contribute to the understanding of extreme violence?
Speaker: Ulrik Malt (Oslo, Norway)
- Mental Health of European youth and scientific evidence for the suicide treatment and prevention
Speaker: Danuta Wasserman (Stockholm, Sweden)
- Future of psychiatric services in the 21st century
Speaker: Dinesh Bhugra (London, United Kingdom)
- Mental disorders and their care through history in Egypt
Speaker: Tarek A. Okasha (Kairo, Egypt)
- Psychiatric Diagnosis: its past, present, and future
Speaker: Allen J. Frances (Coronado, USA)

Congress Organiser
German Association for Psychiatry,
Psychotherapy and Psychosomatics (DGPPN)
Reinhardtstraße 27 B | 10117 Berlin | Germany
TEL: +49 (0) 30-240 477 20
programm@dgppn.de

Congress and Exhibition Office

CPO HANSEN SERVICE

CPO HANSEN SERVICE GmbH | Office Berlin
Paulsborner Straße 44 | 14193 Berlin | Germany
TEL: +49 (0) 30-300 669 0
dgppn13@cpo-hansen.de

■ CME certified

■ English programme track



World Psychiatric
Association WPA



European Psychiatric
Association EPA

S-22	SYMPOSIA
14.30 – 16.00 h	Humboldt Hall
From structure to functioning: neurobiological candidates for the prediction of psychoses	
<i>Chairs: S. Ruhrmann, Cologne, Germany</i>	
<i>S. Wood, Birmingham, United Kingdom</i>	

S-22-001

The contribution of structural brain imaging to the prediction of psychoses

N. Koutsouleris, Munich, Germany

S-22-002

The contribution of MR spectroscopy to the prediction of psychoses

S. Wood, Birmingham, United Kingdom

S-22-003

The contribution of functional imaging to the prediction of psychoses

S. Borgwardt, Basel, Switzerland

S-22-004

Contributions of cognitive neurophysiology to prediction of psychotic disorders

S. Ruhrmann, Cologne, Germany

R. Mueller, M. Bodatsch, J. Klosterkoetter

S-19	SYMPOSIA
14.30 – 16.00 h	Kleist Hall
Should continuous antipsychotic medication be recommended after first episode psychosis?	
<i>Chairs: M. Nordentoft, Copenhagen, Denmark</i>	
<i>L. Wunderink, Groningen, The Netherlands</i>	

S-19-001

Remission of psychotic symptoms and antipsychotic medication – long term follow-up of first episode patients included in the TIPS project

I. Melle, Haslum, Norway

J. I. Rössberg, W. T. Velden Hegelstad, J. H. Evensen, U. Haahr, I. Joa, T. K. Larsen, E. Simonsen, J. O. Johannessen, T. H. McGlashan, S. Friis

S-19-002

A focus on poor physical health in psychosis: from animal data to the long-term follow-up of first episode patients from the AESOP study

V. Mondelli, London, United Kingdom

P. Dazzan

S-19-003

Remission of antipsychotic medication and remission of psychotic symptoms – long term follow-up of first episode patients included in the OPUS trial

M. Nordentoft, Copenhagen, Denmark

S. Austin, O. Mors

S-19-004

Recovery in remitted first episode psychosis at 7-years of follow-up of an early dose-reduction/discontinuation or maintenance treatment strategy

L. Wunderink, Groningen, The Netherlands

D. Wiersma, S. Sytema, F. Nienhuis

S-20	SYMPOSIA
14.30 – 16.00 h	Loft A
The role of neuroinflammation in schizophrenia	
<i>Chairs: A. J. Tanra, Makassar, Indonesia</i>	
<i>M. Ohgidani, Fukuoka, Japan</i>	

S-20-001

Antipsychotics and minocycline as a possible modulator of microglial inflammatory/oxidative stress response in schizophrenia

M. Ohgidani, Fukuoka, Japan

T. Kato

S-20-002

Immature dentate gyrus and mild chronic inflammation: candidate endophenotype of neuropsychiatric disorders

T. Miyakawa, Toyooka, Japan

S-20-003

Low dose of Dextromethorphan may benefit in schizophrenia treatment

R.-B. Lu, Tainan City, Taiwan

S-20-004

The effects of minocycline on microglial cells activation in the dentate gyrus of Gunn rat: a possible animal model of schizophrenia

A. J. Tanra, Makassar, Indonesia

W-02	WORKSHOPS
14.30 – 18.00 h	Loft C
How to apply for EU funding	
<i>Chair: I. Zwoch, Bonn, Germany</i>	

S-21	SYMPOSIA
14.30 – 16.00 h	Einstein Hall
Experimental psychopathology of psychosis	
<i>Chairs: M. Voss, Berlin, Germany</i>	
<i>P. Uhlhaas, Glasgow, United Kingdom</i>	

S-21-001

Delusions and the role of beliefs in perceptual inference

P. Sterzer, Berlin, Germany

S-21-002

Psychophysical and neurochemical aspects of context perception in schizophrenia

J. Terock, Luebeck, Germany

B. Zurowski

S-21-003

Disturbances in the sense of agency in schizophrenia

M. Voss, Berlin, Germany

S-21-004

High-frequency oscillations in schizophrenia: a translational perspective

P. Uhlhaas, Glasgow, United Kingdom

S-18	SYMPOSIA
16.30 – 18.00 h	Humboldt Hall
Perspectives in schizophrenia research: emerging research issues	
Organised by the European Scientific Association on Schizophrenia and other Psychosis (ESAS)	
<i>Chairs: W. Gaebel, Düsseldorf, Germany</i>	
<i>S. Galderisi, Naples, Italy</i>	

S-18-001

Emerging research issues in biological and translational research

P. Falkai, Munich, Germany/W. Maier, Bonn, Germany

S-18-002

Emerging research issues concerning drug and other somatic treatments

H.-J. Möller, Munich, Germany

S-18-003

Emerging research issues concerning psycho-social interventions

W. Rössler, Zurich, Switzerland

S-18-004

Emerging research issues toward recovery: the case of negative and cognitive symptoms

S. Galderisi, Naples, Italy

S-23	SYMPOSIA
16.30 – 18.00 h	Kleist Hall
Implementation of early intervention services for young people with first episode psychosis: rationale, evidence and practical experiences from Europe	
<i>Chairs: A. Bechdolf, Berlin, Germany</i>	
<i>M. Birchwood, Birmingham, United Kingdom</i>	

S-23-001

Why do we need specialized early intervention in first episode psychosis?

A. Bechdolf, Berlin, Germany

S-23-002

The early intervention service reform in the UK: outcomes and the next wave of reform

M. Birchwood, Birmingham, United Kingdom

S-23-003

The EPPIC follow-up study: baseline clinical characteristics and longer-term outcome of first-episode schizophrenia

G. P. Amminger, Parkville, Australia

S-23-004

Implementation of early intervention services in Denmark – from research to practice

M. Nordentoft, Copenhagen, Denmark

S-24	SYMPOSIA
16.30 – 18.00 h	Loft A
Studies using structural and functional neuroimaging to advance understanding of schizophrenia	
<i>Chairs: S. Hodgins, Montreal, Canada B. Schiffer, Bochum, Germany</i>	

S-24-001

Altered contextual modulation of primary visual cortex responses in schizophrenia

*P. Sterzer, Berlin, Germany
K. Seymour*

S-24-002

Mentalizing abilities and their neural underpinnings in different types of offenders with schizophrenia

B. Schiffer, Bochum, Germany

S-24-003

Animacy experience and mentalizing in schizophrenic patients who engage in violent offending

*C. Pawliczek, Aachen, Germany
B. Schiffer*

S-24-004

Grey matter density in different types of violent offenders with schizophrenia

*S. Hodgins, Montreal, Canada
B. Schiffer*

O-04	ORAL PRESENTATIONS
16.30 – 18.00 h	Einstein Hall
Comorbidity	
<i>Chair: N. Sartorius, Geneva, Switzerland</i>	

O-04-001

The role of striatal dopamine in co-morbid addictive states in schizophrenia – revisiting the „self-medication hypothesis“

A. G. Awad, Toronto, Canada

O-04-002

The role of substance abuse in prediction of long-term outcome of schizophrenia – systematic review and meta-analysis

*J. Miettunen, Oulu, Finland
K. Kasurinen, N. Hirvonen, E. Oinas, J. Käkälä, E. Jääskeläinen, A. Alaräisänen*

O-04-003

Is there a relation between reward-disturbances and weight gain caused by antipsychotic medication in patients with schizophrenia?

*M. Nielsen, Roskilde, Denmark
S. Wulff, B. Broberg, E. Rostrup, B. Glenthøj*

O-04-004

Association between cognitive deficits and obsessive-compulsive symptoms in patients with psychosis and un-affected siblings: a 3 year follow-up

*F. Schirmbeck, Mannheim, Germany
M. Swets, M. Zink, R. Kahn, J. van Os, R. Brugge-
man, W. Cahn, A. Bartels, C. J. Meijer, I. Myin-Ger-
meys, L. de Haan*

O-04-005

Dissociation and social cognition in schizophrenia spectrum disorder

*S. Renard, Groningen, The Netherlands
M. Pijnenborg, P. Lysaker*

O-04-006

Multimorbidity in psychotic disorders and their unaffected siblings: an epidemiological perspective

*M. F. Khan, Groningen, The Netherlands
M. A. Islam, P. J. Quee, H. Snieder, E. R. van den Heu-
vel, R. Bruggeman, B. Z. Alizadeh*

S-25	SYMPOSIA
18.15 – 19.45 h	Humboldt Hall
Nosology in the schizophrenic psychoses: new insight from functional neuroimaging and genetics	
<i>Chairs: B. Pfuhlmann, Wuerzburg, Germany J. Foucher, Strasbourg, France</i>	

S-25-001

Cycloid psychosis in a Dutch psychiatric teaching hospital: relevance for diagnosis, treatment and prognosis

*W. Verhoeven, Venray, The Netherlands
N. van de Kerkhof, F. Van der Heijden, M. Schneider, G. Stöber*

S-25-002

Genome-wide search for de novo copy-number variations (CNVs) in cycloid psychoses and chronic schizophrenic psychoses with phenotype correlation

*M. Gawlik, Cardiff, United Kingdom
G. Kirov, E. Rees, L. Georgieva, G. Stoeber*

S-25-003

Functional integration in cycloid psychosis and affect-laden paraphrenia: a double dissociation within the DSM-IV diagnosis of schizophrenia

J. Foucher, Strasbourg, France

S-25-004

New genetic loci for periodic catatonia on chromosome 7p14.1 and 19p12 in a genome-wide association study with pooled DNA

*G. Stöber, Wuerzburg, Germany
D. Schanze, A. B. Ekici, B. Pfuhlmann, A. Reis*

S-26	SYMPOSIA
18.15 – 19.45 h	Kleist Hall
The consequences of childhood trauma in psychotic disorders	
<i>Chairs: I. Melle, Haslum, Norway M. Aas, Oslo, Norway</i>	

S-26-001

Childhood trauma and clinical features in bipolar disorder

*I. Melle, Haslum, Norway
B. Etain, M. Aas, O. A. Andreassen, F. Bellivier, C. Henry*

S-26-002

Biological pathways between childhood trauma and psychosis onset

V. Mondelli, London, United Kingdom

S-26-003

Trauma and neglect in first episode psychosis: preliminary results 2

*A. M. Trauelsen, Copenhagen, Denmark
U. H. Haahr, H.-G. Lyse, M. B. Pedersen, J. E. Jansen, E. Simonsen*

S-26-004

Interactions between BDNF Val66Met, childhood adverse events and brain volume abnormalities in schizophrenia and bipolar disorders

*M. Aas, Oslo, Norway
U. K. Haukvik, S. Djurovic, Ø. Bergmann, S. Lorentzen, O. A. Andreassen, I. Agartz, I. Melle*

S-27	SYMPOSIA
18.15 – 19.45 h	Loft A
Progress in neuropathological post-mortem findings in schizophrenia	
<i>Chairs: A. Schmitt, Munich, Germany</i>	
<i>J. Steiner, Magdeburg, Germany</i>	

S-27-001

Neuropathological assessment of autopsy cases with schizophrenia – recommendations of the Brain Net Europe Consortium
T. Arzberger, Munich, Germany

S-27-002

Histological and gene expression studies of the hippocampus in schizophrenia
A. Schmitt, Munich, Germany
H.-G. Bernstein, J. Steiner, C. Schmitz, B. Bogerts, M. Rossner, P. Falkai

S-27-003

Oligodendrocytes in schizophrenia
J. Steiner, Magdeburg, Germany
H.-G. Bernstein, B. Bogerts

S-27-004

Applying proteomics to schizophrenia post-mortem brain tissue
D. Martins-de-Souza, Munich, Germany

O-05	ORAL PRESENTATIONS
18.15 – 19.45 h	Einstein Hall
Course and outcome	
<i>Chair: V. W. Larach, Santiago, Chile</i>	

O-05-001

Gender differences in first episode psychosis at five-year follow-up – two different courses of disease?
A. Thorup, Copenhagen, Denmark
N. Albert, B. Mette, L. Petersen, P. Jeppesen, P. Le Quarck, M. Nordentoft

O-05-002

Association of familial risk to social, occupational and global outcome in schizophrenia – systematic review and meta-analysis
J. Käkälä, Oulu, Finland
E. Oinas, E. Jääskeläinen, J. Miettunen

O-05-003

The characteristics of self-experiences and the quality of life in persons with schizophrenia and those after spinal-cord injury
B. Horvat, Velika Polana, Slovenia

O-05-004

Quality of life and internalized stigma in patients with schizophrenia: examining the influence of clinical diagnostic and treatment setting
S. Oliveira, Lisboa, Portugal
F. Esteves

O-05-006

Helping people with psychotic disorders back to work – the JUMP study
E. Falkum, Oslo, Norway
J. Lystad, H. Bull, S. Evensen, T. Ueland

S-28	SYMPOSIA
08.30 – 10.00 h	Humboldt Hall
The high risk state for psychosis	
<i>Chairs: J. Klosterkötter, Cologne, Germany</i>	
<i>P. Fusar-Poli, London, United Kingdom</i>	

S-28-001

The ultra high risk approach – current state and future directions

P. Fusar-Poli, London, United Kingdom
A. Yung

S-28-002

The basic symptom approach for identifying individuals at high risk

J. Klosterkötter, Cologne, Germany

S-28-003

The impact of social functioning and Axis-1 diagnoses

R. K. R. Salokangas, Turku, Finland
S. Ruhrmann, H. Graf von Reventlow, M. Heinimaa,
S. Luutonen, T. From, G. Juckel, D. Linszen, P. Ding-
emans, M. Birchwood, P. Patterson, J. Klosterkötter

S-28-004

Searching for neuroimaging markers of the high-risk state of psychosis

S. Borgwardt, Basel, Switzerland

S-29	SYMPOSIA
08.30 – 10.00 h	Kleist Hall
The role of oligodendrocytes in schizophrenia: disease-inherent versus treatment-induced abnormalities	
<i>Chairs: J. Steiner, Magdeburg, Germany</i>	
<i>N. Uranova, Moscow, Russia</i>	

S-29-001

Ultrastructural alterations of myelinated fibers and oligodendrocytes in schizophrenia

N. Uranova, Moscow, Russia
V. Shklover, O. Vikhreva, V. Rachmanova, D. Orlovskaya, P. Kazanskiy, V. Chelpanov

S-29-002

Oligodendrocyte dysfunction in schizophrenia by proteomics

D. Martins-de-Souza, Munich, Germany

S-29-003

Animal experiment data regarding the effect of antipsychotic drugs on oligodendrocyte turnover

L. Xiao, Chongqing, People's Republic of China
H. Wang, J. Niu, H. Wang

S-29-004

Protective role of haloperidol and clozapine on energy-deprived oligodendrocytes in culture

J. Steiner, Magdeburg, Germany
H.-G. Bernstein, B. Bogerts, G. Keilhoff

S-30	SYMPOSIA
08.30 – 10.00 h	Loft A
Oscillations and synchrony in cortical networks in schizophrenia	
Jointly organised by the Asian Network for Schizophrenia Research (ANSR) and the European Scientific Association on Schizophrenia and other Psychosis (ESAS)	
Chairs: J. S. Kwon, Seoul, Republic of Korea S. Ruhrmann, Cologne, Germany	

S-30-001

Oscillations and synchrony in animal models of schizophrenia

T. Sigurdsson, Frankfurt am Main, Germany

S-30-002

High-frequency oscillations in schizophrenia: perspectives from MEG

P. Uhlhaas, Glasgow, United Kingdom

S-30-003

Altered oscillatory activity in the alpha-theta frequency range in schizophrenia patients

*R. Müller, Cologne, Germany
S. Ruhrmann*

S-30-004

Abnormal oscillations and synchrony of MEG in ultra-high risk subjects for psychosis

J. S. Kwon, Seoul, Republic of Korea

O-06	ORAL PRESENTATIONS
08.30 – 10.00 h	Einstein Hall
Treatment	
Chair: A. G. Awad, Toronto, Canada	

O-06-001

Waiting for godot

D. Goel, Invercargill, New Zealand

O-06-002

Preliminary results of the Neuroleptic Strategy Study (NeSSy)

*M. Heinze, Ruedersdorf, Germany
E. Rüther, J. Timm, G. Gründer*

O-06-003

Working out first-episode schizophrenia: neuroanatomical, cognitive and clinical changes following an aerobic exercise intervention

*P. Ward, Liverpool, Australia
A. Watkins, S. Rosenbaum, J. Lagopoulos, L. Taylor, B. Barry, E. G. Trapp, P. Ward, J. Curtis*

O-06-005

Does one program look like the other? A systematic review of practices to measure fidelity to early psychosis intervention standards

*C. Cheng, Thunder Bay, Canada
A. Selick, J. Durbin, S. Moss*

O-06-006

Effectiveness of a community-based early intervention program for psychosis: baseline characteristics and three-month follow-up

*J. Barglow, New York, USA
T. Dole, M. Birnbaum*

O-06-007

Relapses during long-term hospitalization of people suffering from schizophrenia

*G. Bogojevic, Belgrade, Serbia
D. Zigmund, L. Ziravac, U. Pavic*

S-31	SYMPOSIA
10.30 – 12.00 h	Humboldt Hall
Indicated prevention of psychosis	
<i>Chairs: J. Klosterkötter, Cologne, Germany</i>	
<i>M. Birchwood, Birmingham, United Kingdom</i>	

S-31-001

Interventions in people at high risk of psychosis: results of randomized controlled trials

A. Bechdolf, Berlin, Germany

S-31-002

Omega-3 fatty acids for indicated prevention: treatment results and pathomechanisms

G. P. Amminger, Parkville, Australia

M. S. Harris, P. D. McGorry, L. P. Henry

S-31-003

MindNet: a new model of implementation of early intervention services

M. Lambert, Hamburg, Germany

S-31-004

From risk factors to resilience: perspectives for the prevention of mental disorders

S. Ruhrmann, Cologne, Germany

W-03	WORKSHOPS
10.30 – 12.00 h	Kleist Hall
International perspectives of quality of care and integration of persons with schizophrenia	
Jointly organised by the WPA sections on schizophrenia and quality assurance	
<i>Chairs: A. Javed, Nuneaton, United Kingdom</i>	
<i>W. Gaebel, Düsseldorf, Germany</i>	

W-03-001

Long term outcome of schizophrenia in developing and developed countries

N. Sartorius, Geneva, Switzerland

W-03-002

Service availability and utilization and treatment gap for schizophrenic disorders: a survey in 50 low- and middle income countries

A. Lora, Lecco, Italy

W-03-003

The developing countries view on ensuring quality of care

A. Javed, Nuneaton, United Kingdom

W-03-004

Strategy for management of first psychotic episode supported by state law guarantees in a middle-income country

V. W. Larach, Santiago, Chile

W-03-005

Towards a global definition of quality of mental health services – lessons learned from developing a respective EPA guidance

W. Gaebel, Düsseldorf, Germany

S-32	SYMPOSIA
10.30 – 12.00 h	Loft A
Single symptom approaches in schizophrenia: neuronal correlates of auditory hallucinations and language related symptoms	
<i>Chairs: J. Gallinat, Berlin, Germany</i>	
<i>T. Dierks, Bern, Switzerland</i>	

S-32-001

Auditory hallucinations and the language system
T. Dierks, Bern, Switzerland

S-32-002

Hearing voices as a phenomenon of dysconnectivity?
C. Mulert, Hamburg, Germany

S-32-003

Auditory hallucinations and ego-disturbances: imaging of dysfunctional brain networks
J. Gallinat, Berlin, Germany

S-32-004

Non-invasive brain stimulation for the treatment of schizophrenia: neurobiological and clinical aspects
A. Hasan, Munich, Germany

PL-04	PLENARY LECTURES
12.15 – 13.00 h	Humboldt Hall
Twenty years of early intervention in psychosis: how critical is the critical period hypothesis?	
<i>Chair: J. Klosterkötter, Cologne, Germany</i>	

PL-04-001

Twenty years of early intervention in psychosis: how critical is the critical period hypothesis?
M. Birchwood, Birmingham, United Kingdom

S-33	SYMPOSIA
10.30 – 12.00 h	Einstein Hall
The schizophrenia motor dimension: clinical relevance and neurobiology	
<i>Chairs: S. Walther, Bern, Switzerland</i>	
<i>M. Morrens, Antwerp, Belgium</i>	

S-33-001

Parsing the components of psychomotor functioning in schizophrenia
M. Morrens, Antwerp, Belgium

S-33-002

Motor signs in individuals at risk of schizophrenia
P. N. van Harten, Maastricht, The Netherlands

S-33-003

Clinical and cerebral correlates of neurological soft signs in schizophrenia
J. Schröder, Heidelberg, Germany

S-33-004

Dysfunctional subcortico-cortical interactions in the motor loop as probable cause for hypokinesia in schizophrenia
S. Walther, Bern, Switzerland

P-10	POSTER SESSIONS
13.30 – 14.30 h	Foyer
Treatment (psychosocial) 3	
Chair: T. Lincoln, Hamburg, Germany	

P-10-001

Metacognitive training for patients with schizophrenia: preliminary evidence for a targeted single-module program

R. Balzan, Adelaide, Australia

P. Delfabbro, C. Galletly, T. Woodward

P-10-002

Cognitive remediation therapy in schizophrenia

M. Fiste, Chaidari-Athens, Greece

M. Papagathaggelou, N. Lytra, E. Thermou, E. Neroutsos

P-10-003

Does the integrated psychological therapy improve neurocognition and social-functioning in patients with schizophrenia?

A. Taksal, Bangalore, India

P. Sudhir, K. Kumar, J. Thirthalli, D. Vishwanath

P-10-004

Rehabilitation of communicative abilities in schizophrenic patients through the cognitive pragmatics treatment: a pilot study

F. M. Bosco, Turin, Italy

I. Gabbatore, E. Geda, P. Gastaldo, F. Cauda, R. Angeleri, E. Pirfo, T. Costa, S. Duca, B. G. Bara, K. Sacco

P-10-005

Cognitive-behavioral therapy and negative symptoms of schizophrenia

M. Fiste, Chaidari-Athens, Greece

E. Neroutsos, N. Lytra, G. Triantafyllou, E. Thermou

P-10-006

Effectiveness of group therapy aimed at overcoming schizophrenia

A. M. Rojas Rivera, San Antonio, Chile

P-10-007

Behavioral Activation for Negative Symptoms (BANS-NL): a nurse intervention for psychotic disorders

A. Malda, Leeuwarden, The Netherlands

M. Pijnenborg, N. Boonstra, A. Aleman

P-10-008

Comparing psychological interventions of different complexities with clinical outcomes in a high risk or psychotic adolescent sample

P. Palombi, Roma, Italy

A. Marconi, G. Colafrancesco, M. Ferrara

P-10-010

Competitive work and schizophrenia: design of a project aiming at obtaining and keeping a job through supported employment and multifaceted collaboration

T. Kivekäs, Helsinki, Finland

K. Ahola, N. Nevala, K.-P. Martimo

P-11	POSTER SESSIONS
13.30 – 14.30 h	Foyer
Risk states	
<i>Chair: R. K. Salogankas, Turku, Finland (tbc)</i>	

P-11-001

Perception of neutral and negative stimuli in unaffected first-degree relatives of patients with schizophrenia

*N. Klaasen, Groningen, The Netherlands
J. van der Velde, P. Gromann, M. Swart, E. Opmeer,
D. Wiersma, R. Bruggeman, L. de Haan, L. Krabben-
dam, A. Aleman*

P-11-002

Emotion recognition as a predictor of transition to a psychotic disorder in ultra-high risk patients

*M. Schaefer, Parkville, Australia
K. Allott, A. Thompson, B. Nelson, S. Bendall, C. Bartholomeusz, P. McGorry, M. Schloegelhofer, A. Bechdolf, G. P. Amminger*

P-11-003

Mothers of schizophrenia patients: features of executive functions and face recognition

*N. Khamenka, Minsk, Belarus
M. Skuhareuskaya*

P-11-004

Social cognition, language and social functioning in children with genetic high risk for developing schizophrenia and bipolar disorder

*C. J. Christiani, Copenhagen, Denmark
J. R. Møllegaard Jepsen, A. A. Thorup, N. Hemager,
D. V. Ellersgaard, B. K. Burton, A. Ranning, N. O. Mors, K. Plessen, M. Nordentoft*

P-11-005

Neurocognitive profiles in 7-year-old offspring of parents with schizophrenia or with bipolar disorder – part of the Danish High Risk and Resilience Study „VIA 7”

*N. Hemager, Copenhagen, Denmark
J. R. Møllegaard Jepsen, A. Thorup, C. A. Jerlang Christiani, A. Ranning, B. K. Burton, D. V. Ellersgaard, M. Skjærbæk, N. P. Ole Mors, M. Nordentoft, K. J. Plessen*

P-11-006

Psychopathology in offspring of parents with schizophrenia or bipolar disorder – Associations with neurodevelopmental disturbances and childhood stress. Part of the Danish high risk and resilience study – VIA 7

*D. Ellersgaard, Copenhagen, Denmark
A. Thorup, J. R. Jepsen, B. K. Burton, C. J. Christiani,
N. Hemager, M. Skjærbæk, A. Ranning, O. Mors, K. J. Plessen, M. Nordentoft*

P-11-007

Maturation of mismatch negativity – implications for ultra high risk schizophrenia research

*R. Thienel, Waratah, Australia
R. Fulham, B. Weismueller, N. Hanzon-Kilberg, H. Stain, B. Patch, U. Schall, J. Todd*

P-11-008

Comparison of two video-based assessments for abnormal motor behavior in adolescents at risk for psychosis

*S. Schiebler, Bern, Switzerland
A. Tolev, K. Stegmayer, D. Hubl, W. Strik, F. Schultze-Lutter, B. Schimmelmann, S. Walther*

P-11-009

Brain activation during self-reflection in ultra-high risk for psychosis

*E. Opmeer, Groningen, The Netherlands
E. Liemburg, J. van der Velde, R. Nieboer, L. Wunderink, A. Aleman*

P-11-010

Formal thought disorder in high-risk for psychosis individuals

*M. Skuhareuskaya, Minsk, Belarus
Y. Fralova, N. Danilevich, E. Kudina*

P-11-011

Neurocognition and catechol-O-methyltransferase Val/Met polymorphism in high-risk for psychosis individuals

*M. Skuhareuskaya, Minsk, Belarus
V. Objedkov, I. Halayenka*

P-11-012

Adolescents at ultra-high risk for psychosis with and without 22q11 deletion syndrome: a comparison of prodromal psychotic symptoms and general functioning

M. Armando, Rome, Italy

S. Vicari, P. Girardi, D. Menghini, M. Digilio, M. Pontillo, R. Saba, L. Mazzone, A. Lin, M. Schafer, P. Amminger

P-12

POSTER SESSIONS

13.30 – 14.30 h

Foyer

Structural neuroimaging

Chair: A. Schmitt, Munich, Germany

P-12-001

White matter abnormalities in first episode psychosis: a DTI study

T. Melicher, Prague, Czech Republic

P. Mikolas, F. Spaniel, J. Horacek, P. Mohr

P-12-002

Processing speed impairment is related to white matter damage in schizophrenia

J. Pena, Bilbao, Spain

O. Rilo, N. Ibarretxe, O. Rusu, A. Loizaga, R. Avila, C. Schretlen, M. Varvaris, N. Ojeda

P-12-003

White matter pathways of the salience system are altered in schizophrenia

T. Bracht, Bern, Switzerland

H. Horn, W. Strik, A. Federspiel, N. Razavi, K. Stegmayer, R. Wiest, T. Dierks, T. Mueller, S. Walther

P-12-004

Grey matter differences between bipolar patients and controls: a voxel-based morphometry meta-analysis

R. Ganzola, Quebec, Canada

S. Duchesne

P-12-005

Incidental radiological findings on brain magnetic resonance imaging in patients with first-episode psychosis and healthy controls

I. Falkenberg, Marburg, Germany

S. Benetti, W. Pettersson-Yeo, P. Dazzan, A. Simmons, S. Williams, P. McGuire

P-12-006

Structural alterations of the visual system in adolescents with first-admission schizophrenia

R. Henze, Heidelberg, Germany

R. Brunner, P. Parzer, M. Freitag, U. Thiemann, F. Resch, B. Stieltjes

P-12-007

Alterations of hippocampal volumes and serum BDNF levels in association to atypical antipsychotics in a sample of first episode of schizophrenic patients

E. Rizos, Athens, Greece

M. Papathanasiou, P. Michalopoulou, E. Laskos, A. Kastania, A. Douzenis, K. Vasilopoulou, I. Liappas

P-12-008

Proton MRS findings in the corpus callosum genu and auditory information processing in young male patients with schizophrenia

I. Lebedeva, Moscow, Russia

N. Semenova, S. Sidorin, V. Kaleda, A. Barkhatova, T. Akhadov

P-13	POSTER SESSIONS
13.30 – 14.30 h	Foyer
Neuropsychology 3	
Chair: P. Uhlaas, Glasgow, United Kingdom	

P-13-001

Spatial cognition in schizophrenia patients measured in virtual reality tests based on animal research

M. Rodriguez, Prague, Czech Republic

I. Fajnerova, K. Vlcek, C. Brom, L. Konradova, K. Dvorska, P. Mikolas, D. Levick, J. Horacek, A. Stuhlik

P-13-002

Mismatch negativity in birds

U. Schall, Callagahn, Australia

B. Müller, C. Kärger, O. Güntürkün

P-13-003

Sensorimotor learning in stable schizophrenia patients compared to healthy young and elderly controls in two variations of the rotary pursuit

L. De Picker, Antwerp, Belgium

W. Hulstijn, G. Dumont, B. Sabbe

P-13-004

A study of Neurological Soft Signs (NSS) in schizophrenia

C. S. Gupta, New Delhi, India

T. Gupta, S. Pattanayak, S. Aggarwal

P-13-005

Predictive value of executive functions impairment in early-onset schizophrenia spectrum psychosis: 6 years follow-up study

B. Remberk, Warsaw, Poland

A. K. Bazyńska, J. Bragoszewska, F. Rybakowski

P-13-007

Neurocognitive predictors of symptom severity in first-episode schizophrenia

C. Mohn, Drammen, Norway

A.-K. Torgalsbøen

P-13-008

Absorption and dissociative detachment, but not compartmentalisation, are associated with psychosis-like experiences in the general population

C. Humpston, London, United Kingdom

V. Bell, M. Mehta, Q. Deeley

P-13-009

Aberrant salience attribution in schizophrenia patients and healthy participants with delusional experiences

S. Diner, Berlin, Germany

A. Pankow, T. Katthagen, S. Koch, L. Deserno, A. Heinz, F. Schlagenhauf

P-13-010

Willed actions and mechanisms of initiation, production and control of cognitive responses in schizophrenia: a cue-based protocol

R. Rinaldi, Mons, Belarus

L. Lefebvre

S-34	SYMPOSIA
14.30 – 16.00 h	Humboldt Hall
Obsessive-compulsive symptoms in schizophrenia	
<i>Chairs: M. Zink, Mannheim, Germany</i>	
<i>N. Fineberg, Hertfordshire, United Kingdom</i>	

S-34-001

Obsessive compulsive symptoms in the early course of psychotic disorders

F. Schirmbeck, Mannheim, Germany

S-34-002

Neurocognitive differences between schizophrenia patients with and without comorbid obsessive-compulsive symptoms

N. Fineberg, Hertfordshire, United Kingdom

D. Patel, K. Mukhopadhyaya, K. Laws

S-34-003

Antiserotonergic antipsychotics such as clozapine induce or aggravate obsessive compulsive symptoms in schizophrenia

M. Zink, Mannheim, Germany

S-34-004

Effectiveness and outcome predictors of cognitive-behavioral therapy for obsessive-compulsive disorder co-occurring with psychosis

A. Tundo, Rome, Italy

L. Salvati, L. Cieri, M. Daniele, D. Di Spigno, R. Necci,

A. Parena

S-35	SYMPOSIA
14.30 – 16.00 h	Kleist Hall
Psychological treatments for people with schizophrenia	
<i>Chairs: S. Ochoa, Sant Boi de Llobregat, Spain</i>	
<i>J. Usall, Sant Boi de Llobregat, Spain</i>	

S-35-001

REPYFLEC cognitive remediation group training in schizophrenia – looking for an integrative approach

J. Usall, Sant Boi de Llobregat, Spain

A. Farreny

S-35-002

Metacognitive training in schizophrenia (MCT): immediate, delayed and „sleeper“ effects

S. Moritz, Hamburg, Germany

S-35-003

Cognitive-behavioral therapy for people with auditory hallucinations

E. Lorente, Valencia, Spain

S-35-004

A randomized, controlled trial of neurocognitive training in schizophrenia

M. Linke, Warsaw, Poland

M. Jarema, A. Wichniak, K. Jankowski

S-36	SYMPOSIA
14.30 – 16.00 h	Loft A
Animal models of schizophrenia facing the complexity of genotype, environmental factors and phenotype	
<i>Chairs: R. Wolf, Bochum, Germany</i>	
<i>M. von Wilmsdorff, Düsseldorf, Germany</i>	

S-36-001

Differences in social behavior, prepulse inhibition, dopaminergic and serotonergic hippocampal fiber density of CPB-K mice compared to BALB/cJ mice

P. Panther, Magdeburg, Germany

S. Nullmeier, A. Kröber, S. Herbert, R. Wolf

S-36-002

Pre-treatment with the mGlu2/3 receptor agonist LY379268 attenuates DOI-induced impulsive responding, deficits in prepulse inhibition and regional c-Fos protein expression

L. Wischhof, Bremen, Germany

M. Koch

S-36-003

Disturbed gene expression caused by perinatal hypoxia in an animal model of schizophrenia

A. Schmitt, Munich, Germany

P. Gebicke-Härter, P. Falkai

S-36-004

Sex-dependent metabolic changes caused by drug treatment with haloperidol and clozapine in rats

M. von Wilmsdorff, Düsseldorf, Germany

O-07	ORAL PRESENTATIONS
14.30 – 16.00 h	Einstein Hall
Structural neuroimaging	
<i>Chairs: U. Schall, Callagahn, Australia</i>	

O-07-001

Factors associating to brain volume change in schizophrenia – the Northern Finland 1966 Birth Cohort

S. Huhtaniska, Oulu, Finland

T.-M. Paaso, M. Kyllönen, J. Moilanen, M. Haapea, G. Murray, P. Jones, J. Miettunen, M. Isohanni, J. Veijola, E. Jääskeläinen

O-07-002

Familial and unique environmental influences on brain volumes in twins with schizophrenia

M. Picchioni, Northampton, United Kingdom

T. Touloupoulou, C. Chaddock, J. Cole, U. Ettinger, A. Oses, R. Murray, P. McGuire

O-07-003

Greater reductions in grey matter volume in a cognitive-deficit subtype of schizophrenia

A. Shepherd, Darlinghurst, Sydney, Australia

J. Wong, M. Dragovic, K. Laurens, A. Jablensky, V. Carr, M. Green

O-07-004

Supplementary motor area (SMA) volume correlates with psychotic symptoms associated with dysregulation of the motor system – A voxel-based morphometry (VBM) study

K. Stegmayer, Bern, Switzerland

H. Horn, A. Federspiel, N. Razavi, K. Laimböck, T. Bracht, W. Strik, T. Müller, R. Wiest, S. Walther

O-07-005

Relevance of posterior parietal areas for auditory verbal hallucination in schizophrenia: a voxel-based grey and white matter morphometry study

M.-J. van Tol, Groningen, The Netherlands

L. van der Meer, R. Bruggeman, G. Modinos, H. Knegtering, A. Aleman

O-07-006

Structural brain imaging correlates of At-Risk Mental State

U. Schall, Callagahn, Australia

T. Ehlfes, P. Michie, R. Atkinson, P. Ward

FLOOR PLAN

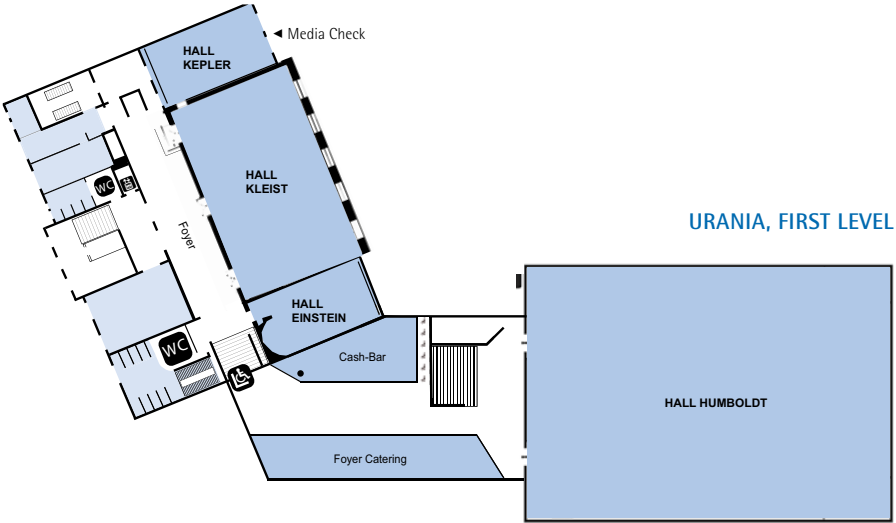
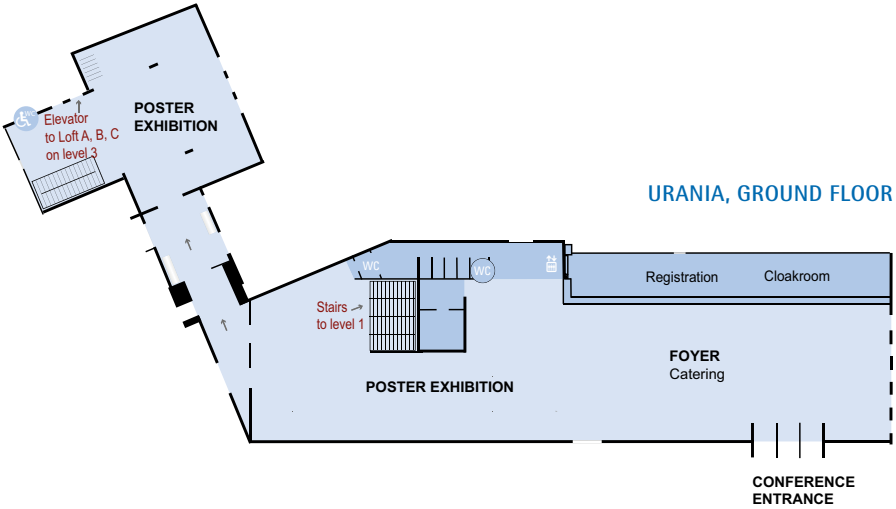

URANIA, THIRD LEVEL

Lofts A, B and C with access via elevator on floor.

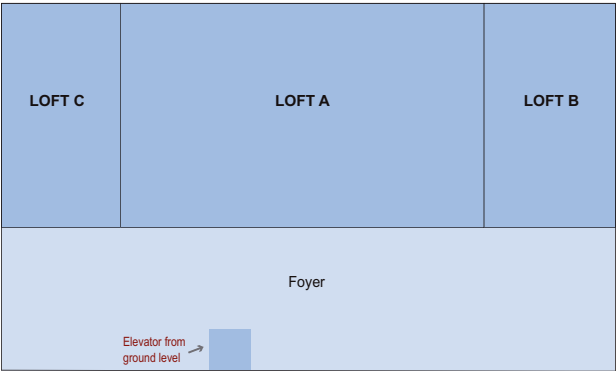

ACKNOWLEDGMENTS

The organisers of the 4th European Conference on Schizophrenia Research (ECSR) gratefully acknowledge the support of:



Roche Pharma AG in terms of sponsoring (EUR 10.000)



German Research Association (DFG) in terms of an educational grant

Anzeige

